



GIOVENZANA
INTERNATIONAL B.V.



GIOVENZANA
INTERNATIONAL B.V.



PHOENIX CAM SWITCHES
REAR PANEL MOUNTING - R

REAR PANEL MOUNTING

| RANGE AC21A | 12A - 16A - 20A |

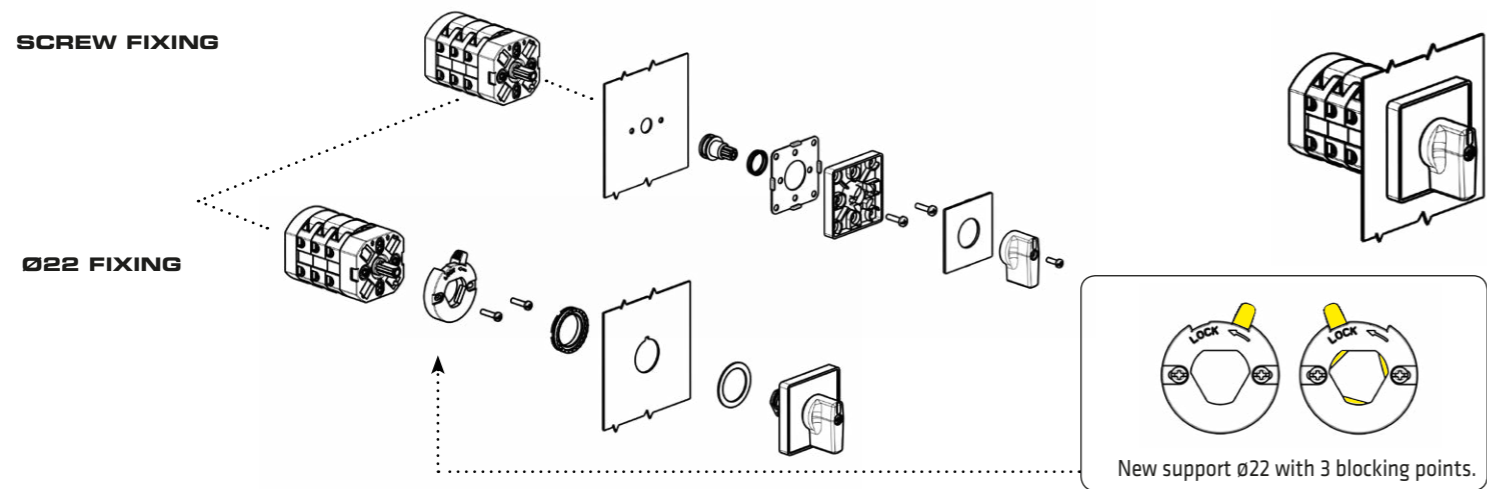

| RANGE AC21A | 25A - 32A - 40A |

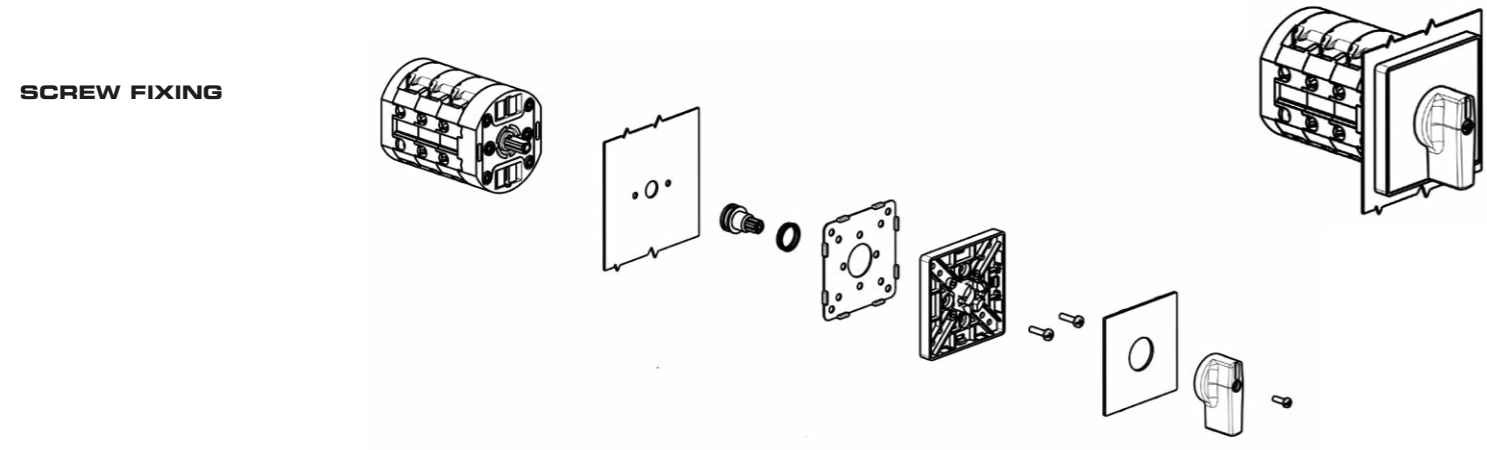

| RANGE AC21A | 63A - 80A |

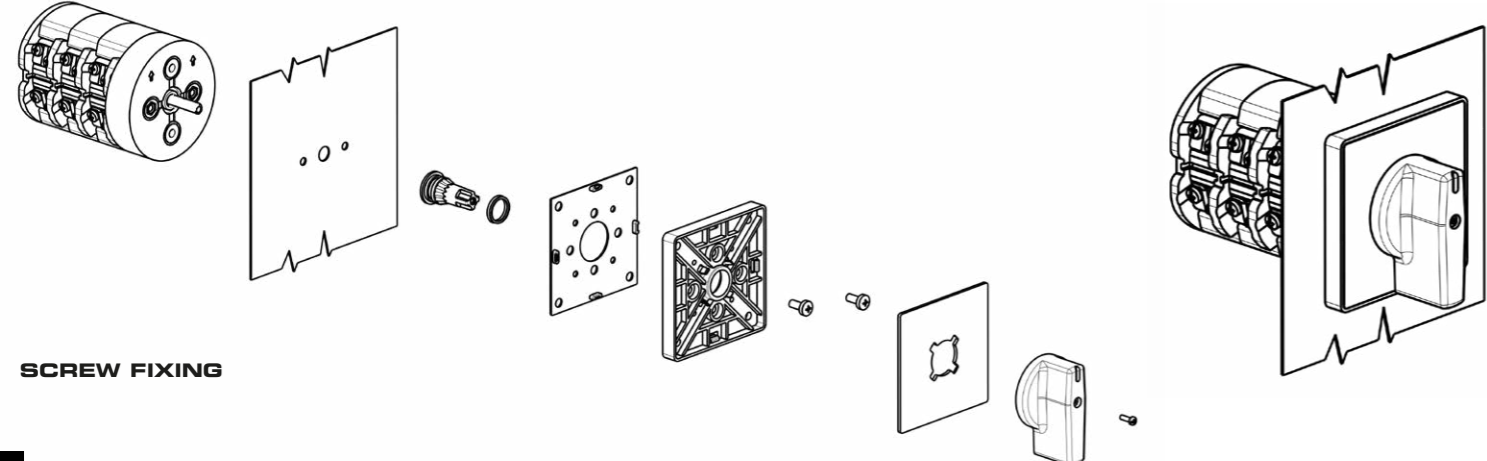

| RANGE AC21A | 125A |

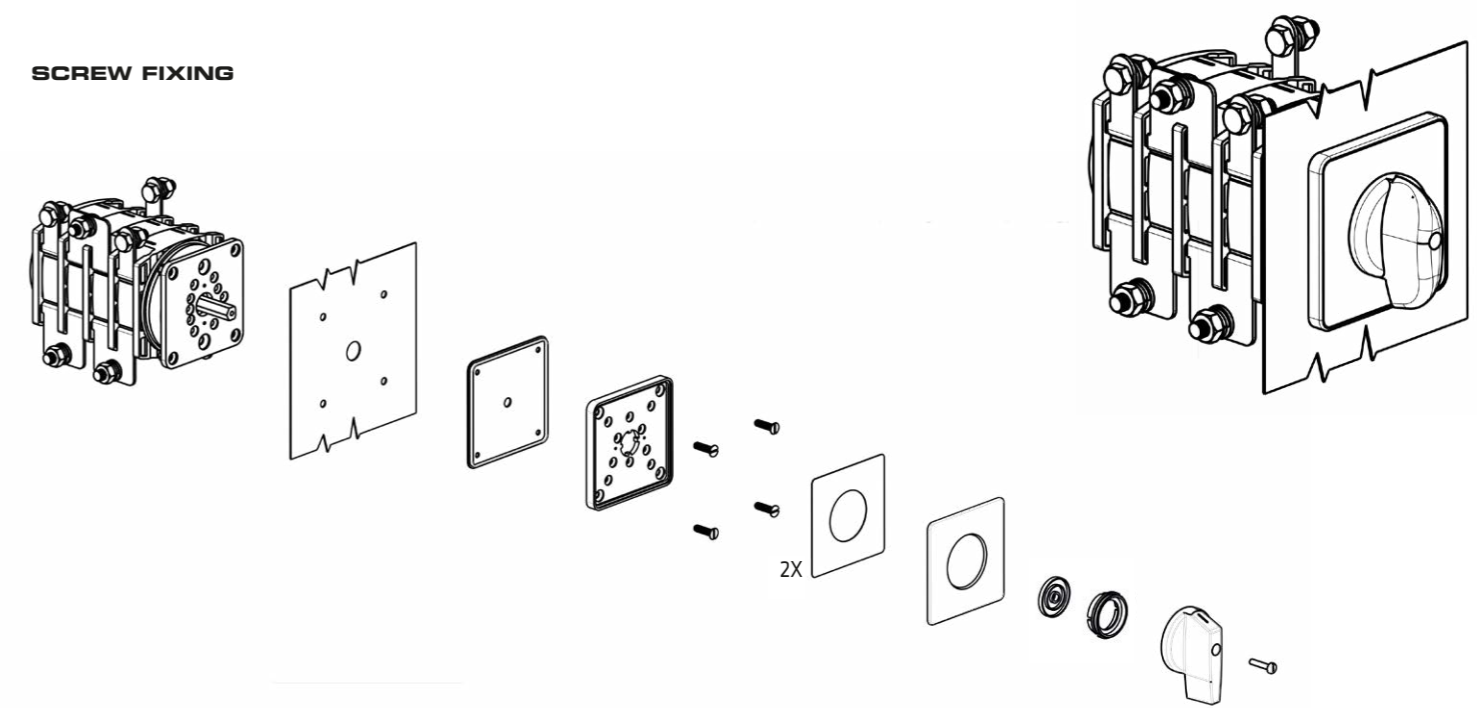

| RANGE AC21A | 200A |

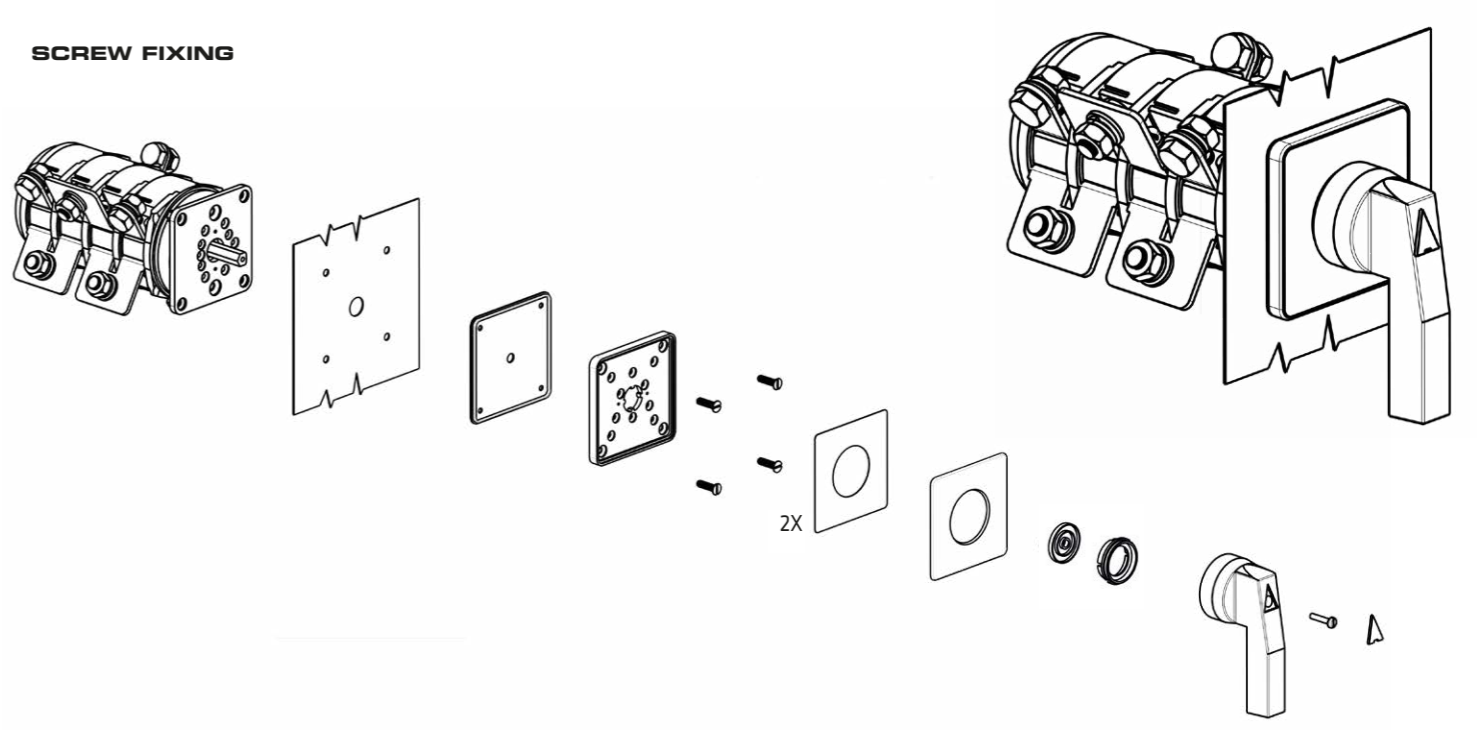



REAR PANEL MOUNTING

PROTECTION CLASS EN60529 - IP65 UL50 NEMA TYPE 1-4-4X-12

	12-16-20A		90°
	25-32-40A		90°
	63-80A		1 2
	125A		1 3 2 4
	200A		1 3 5 2 4 6
	200A		1 3 5 7 2 4 6 8
	200A		1 3 5 7 9 2 4 6 8 10
	200A		1 3 5 7 9 11 2 4 6 8 10 12
	200A		1 3 5 2 4 6

SERIES	AC21A	1 POLE	2 POLES	3 POLES	4 POLES	5 POLES	6 POLES	3 POLES WITH SPRING RETURN TO ZERO
P012	12A	P0120001R	P0120002R	P0120003R	P0120004R	P0120005R	P0120006R	P0120007R
P016	16A	P0160001R	P0160002R	P0160003R	P0160004R	P0160005R	P0160006R	P0160007R
P020	20A	P0200001R	P0200002R	P0200003R	P0200004R	P0200005R	P0200006R	P0200007R
C025	25A	C0250001R	C0250002R	C0250003R	C0250004R	C0250005R	C0250006R	C0250007R
C032	32A	C0320001R	C0320002R	C0320003R	C0320004R	C0320005R	C0320006R	C0320007R
C040	40A	C0400001R	C0400002R	C0400003R	C0400004R	C0400005R	C0400006R	C0400007R
C063	63A	C0630001R	C0630002R	C0630003R	C0630004R	C0630005R	C0630006R	-
C080	80A	C0800001R	C0800002R	C0800003R	C0800004R	C0800005R	C0800006R	-
G125	125A	-	G1250002R	G1250003R	G1250004R	-	G1250006R	-
G200	200A	-	G2000002R	G2000003R	G2000004R	-	G2000006R	-

ACTUATOR	FIXING	P012 - P016 - P020				C025 - C032 - C040			C063 - C080		G125	G200
		90°	90°	45°	NO	90°	90°	45°	90°	90°	90°	90°
	screw	001/0001	001/0001-1	001/0007	-	007/0001	007/0001-1	007/0007	201/0001	201/0001-1	441/0001	461/0001
	ø22	056X/0001	056X/0001-1	056X/0007	-	-	-	-	-	-	-	-
	screw	002/0001	002/0001-1	002/0007	-	008/0001	008/0001-1	008/0007	-	-	-	-
	ø22	058X/0001	058X/0001-1	058X/0007	-	-	-	-	-	-	-	-
	screw	003/0001	003/0001-1	003/0007	-	003/0001	003/0001-1	003/0007	-	-	-	-
	ø22	059X/0001	059X/0001-1	-	-	-	-	-	-	-	-	-
	screw	004/0001	004/0001-1	004/0007	-	004/0001	004/0001-1	004/0007	-	-	-	-
	ø22	060X/0001	060X/0001-1	-	-	-	-	-	-	-	-	-
	screw	009/0001	009/0001-1	009/0007	-	009/0001	009/0001-1	009/0007	209/0001	209/0001-1	449/0001	449/0001
	ø22	061X/0001	061X/0001-1	061X/0007	-	-	-	-	-	-	-	-
	screw	010/0001	010/0001-1	010/0007	-	010/0001	010/0001-1	010/0007	210/0001	210/0001-1	450/0001	450/0001
	ø22	062X/0001	062X/0001-1	062/0007	-	-	-	-	-	-	-	-
	ø22	057X/0001	057X/0001-1	057X/0007	-	-	-	-	-	-	-	-
	ø22	-	-	-	028X	-	-	-	-	-	-	-
	ø22	-	-	-	029X	-	-	-	-	-	-	-

UL50 NEMA Type 1-4-4X
 Key removable at "0" position
 Body mounting rotated by 90°
 Key removable at 0° and 180°



REAR PANEL MOUNTING

PROTECTION CLASS EN60529 - IP65 UL50 NEMA TYPE 1-4-4X-12

12-16-20A	
25-32-40A	
63-80A	
125A	
200A	

SERIEs	AC21A	1 POLE	2 POLES	3 POLES	4 POLES
P012	12A	P0120008R	P0120009R	P0120010R	P0120011R
P016	16A	P0160008R	P0160009R	P0160010R	P0160011R
P020	20A	P0200008R	P0200009R	P0200010R	P0200011R
C025	25A	C0250008R	C0250009R	C0250010R	C0250011R
C032	32A	C0320008R	C0320009R	C0320010R	C0320011R
C040	40A	C0400008R	C0400009R	C0400010R	C0400011R
C063	63A	C0630008R	C0630009R	C0630010R	C0630011R
C080	80A	C0800008R	C0800009R	C0800010R	C0800011R
G125	125A	G1250008R	G1250009R	G1250010R	G1250011R
G200	200A	G2000008R	G2000009R	G2000010R	G2000011R

ACTUATOR	FIXING	P012 - P016 - P020	C025 - C032 - C040	C063 - C080	G125	G200
		45°	NO	45°	60°	60°
	screw	001/0008	-	007/0008	201/0008	441/0008
	ø22	056X/0008	-	-	-	-
	screw	002/0008	-	008/0008	-	-
	ø22	058X/0008	-	-	-	-
	screw	003/0008	-	003/0008	-	-
	ø22	059X/0008	-	-	-	-
	screw	004/0008	-	004/0008	-	-
	ø22	060X/0008	-	-	-	-
	screw	009/0008	-	009/0008	209/0008	-
	ø22	061X/0008	-	-	-	-
	screw	010/0008	-	010/0008	210/0008	-
	ø22	062X/0008	-	-	-	-
	ø22	057X/0008-CA	-	-	-	-
	ø22	-	028X	-	-	-
	ø22	-	029X	-	-	-

UL50 NEMA Type 1-4-4X
 Key removable at "0" position
 Body mounting rotated by 90°
 Key removable at 0° and 180°

REAR PANEL MOUNTING

PROTECTION CLASS EN60529 - IP65 UL50 NEMA TYPE 1-4-4X-12



12-16-20A

25-32-40A

63-80A

125A

200A

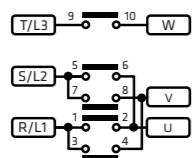
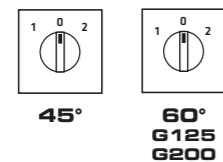

3				
9-10	X		X	
7-8	X			
5-6			X	
3-4			X	
1-2	X			
WAF	CONT.	1	0	2

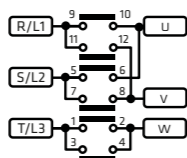
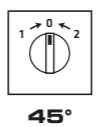
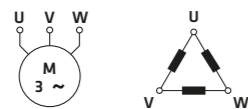
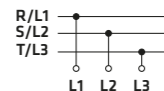

3				X
11-12	X			
9-10	X			
7-8	X			
5-6			X	
3-4			X	
1-2	X			
WAF	CONT.	1	0	2

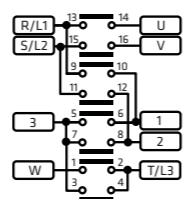
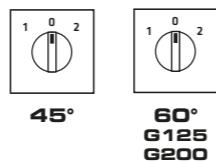
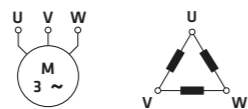
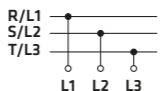

4				X
15-16				X
13-14				
11-12	X			
9-10	X			
7-8			X	
5-6			X	
3-4	X			
1-2	X			
WAF	CONT.	1	0	2

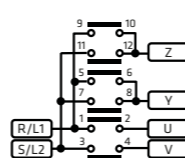
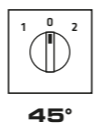
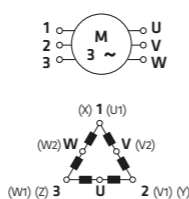
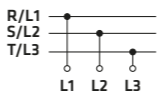

3				X
11-12	X			
9-10				X
7-8			X	
5-6	X			
3-4	X		X	
1-2	X		X	
WAF	CONT.	1	0	2

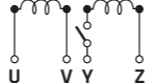
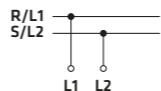

SERIES	AC21A	REVERSING SWITCH 3 POLES	REVERSING SWITCH 3 POLES WITH SPRING RETURN TO ZERO	DAHLENDER POLE CHANGING TWO SPEED SWITCH	REVERSING SWITCH SINGLE PHASE WITH CENTRIFUGAL CUT-OUT
P012	12A	P0120012R	P0120013R	P0120014R	P0120016R
P016	16A	P0160012R	P0160013R	P0160014R	P0160016R
P020	20A	P0200012R	P0200013R	P0200014R	P0200016R
C025	25A	C0250012R	C0250013R	C0250014R	C0250016R
C032	32A	C0320012R	C0320013R	C0320014R	C0320016R
C040	40A	C0400012R	C0400013R	C0400014R	C0400016R
C063	63A	C0630012R	-	C0630014R	-
C080	80A	C0800012R	-	C0800014R	-
G125	125A	G1250012R	-	G1250014R	-
G200	200A	G2000012R	-	G2000014R	-

ACTUATOR	FIXING	P012 - P016 - P020			C025 - C032 - C040		C063 - C080	G125	G200
		45°	45°	NO	45°	45°	45°	60°	60°
	screw ø22	001/0008 056X/0008	001/0013 056X/0013	-	007/0008	007/00013	201/0008	441/0008	461/0008
	screw ø22	002/0008 058X/0008	002/0013 058X/0013	-	008/0008	-	-	-	-
	screw ø22	003/0008 059X/0008	003/0013 059X/0013	-	003/0008	003/0013	-	-	-
	screw ø22	004/0008 060X/0008	004/0013 060X/0013	-	004/0008	004/0013	-	-	-
	screw ø22	009/0008 061X/0008	009/0013 061X/0013	-	009/0008	009/0013	209/0008	-	-
	screw ø22	010/0008 062X/0008	010/0013 062X/0013	-	010/0008	010/0013	210/0008	-	-
	ø22	057X/0008-CA	057X/0013-CA	-	-	-	-	-	-
	ø22	-	-	028X	-	-	-	-	-
	ø22	-	-	029X	-	-	-	-	-

UL50 NEMA Type 1-4-4X
 Body mounting rotated by 90°
 Key removable at "0" position
 Key removable at 0° and 180°

REAR PANEL MOUNTING

PROTECTION CLASS EN60529 - IP65 UL50 NEMA TYPE 1-4-4X-12



12-16-20A

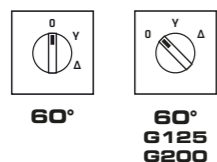

25-32-40A

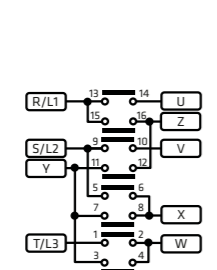

125A

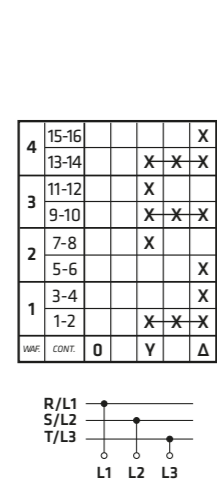

200A

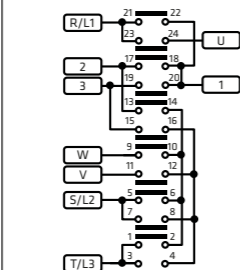
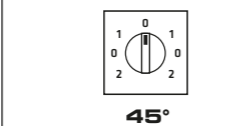
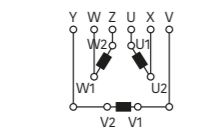

23-24	X				X
21-22		X	X		
19-20	X				X
17-18	X				X
15-16		X	X		
13-14		X	X		
11-12	X				X
9-10	X				X
7-8	X				
5-6				X	X
3-4	X	X			
1-2			X	X	
WAF	CONT.	0	1	0	2

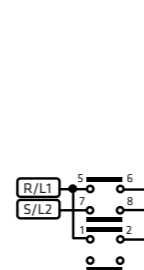
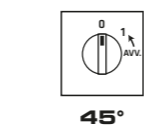
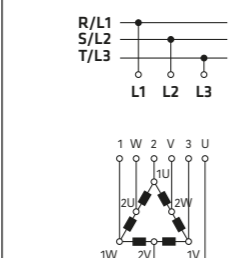

7-8	X	X
5-6	X	X
1-2		X
WAF	CONT.	0 1 AVV.

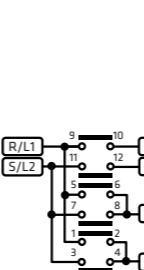
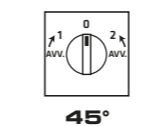
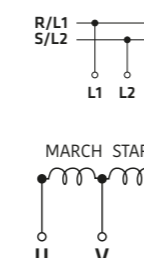

11-12	X	X	X	X
9-10	X	X	X	X
7-8	X			X
5-6	X			
3-4	X	X		
1-2			X	X
WAF	CONT.	AVV.	1 0 2	AVV.

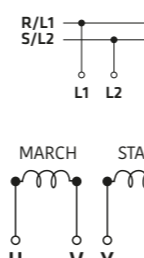

SERIES	AC21A	STAR-DELTA STARTER SWITCH	REVERSING-DAHLANDER POLE CHANGING TWO SPEED SWITCH	STARTER WITH SINGLE PHASE WITH AUXILIARY PHASE	REVERSING-STARTER SWITCH SINGLE PHASE WITH AUXILIARY PHASE
P012	12A	P0120015R	P0120031R	P0120017R	P0120018R
P016	16A	P0160015R	P0160031R	P0160017R	P0160018R
P020	20A	P0200015R	P0200031R	P0200017R	P0200018R
C025	25A	C0250015R	C0250031R	-	-
C032	32A	C0320015R	C0320031R	-	-
C040	40A	C0400015R	C0400031R	-	-
C063	63A	-	-	-	-
C080	80A	-	-	-	-
G125	125A	G1250015R	-	-	-
G200	200A	G2000015R	-	-	-

ACTUATOR	FIXING	P012 - P016 - P020					C025 - C032 C040		C063 - C080	G125	G200
		60°	45°	45°	45°	NO	60°	45°	60°	60°	60°
	screw	001/0015	001/0031	001/0017	001/0018	-	007/0015	007/0031	-	441/0015	461/0015
	ø22	056X/0015	056X/0031	056X/0017	056X/0018	-	-	-	-	-	-
	screw	002/0015	002/0031	002/0017	002/0018	-	008/0015	008/0031	-	-	-
	ø22	-	-	-	-	-	-	-	-	-	-
	screw	003/0015	003/0031	003/0017	003/0018	-	003/0015	003/0031	-	-	-
	ø22	-	-	-	-	-	-	-	-	-	-
	screw	004/0015	004/0031	004/0017	004/0018	-	004/0015	004/0031	-	-	-
	ø22	-	-	-	-	-	-	-	-	-	-
	screw	009/0015	009/0031	009/0017	009/0018	-	009/0015	009/0031	-	-	-
	ø22	-	-	-	-	-	-	-	-	-	-
	screw	010/0015	010/0031	010/0017	010/0018	-	010/0015	010/0031	-	-	-
	ø22	-	-	-	-	-	-	-	-	-	-
	ø22	-	-	-	-	-	-	-	-	-	-
	ø22	-	-	-	-	-	-	-	-	-	-
	ø22	-	-	-	-	-	-	-	-	-	-
	ø22	-	-	-	-	-	-	-	-	-	-



REAR PANEL MOUNTING

PROTECTION CLASS EN60529 - IP65 UL50 NEMA TYPE 1-4-4X-12



12-16-20A

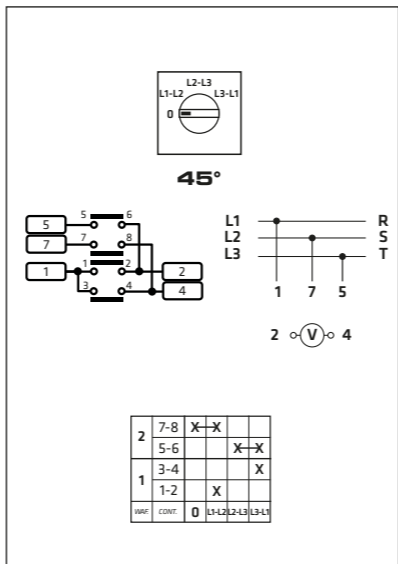
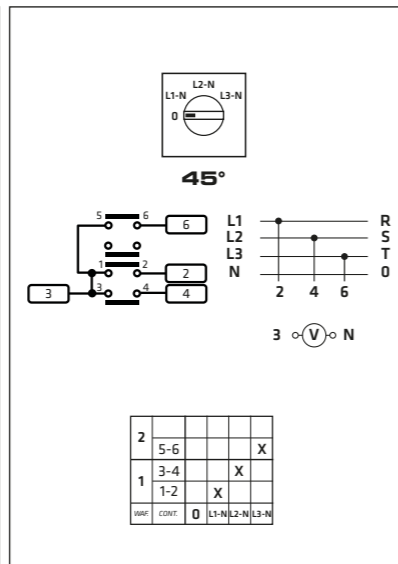
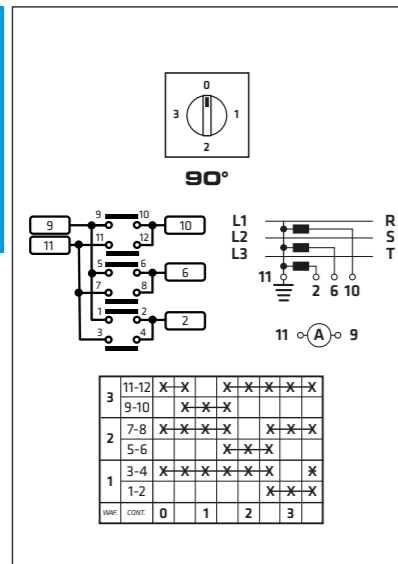

SERIES	AC21A	AMMETER SELECTOR SWITCH 1 POLE FOR 3 CURRENT TRANSFORMERS	VOLTMETER SELECTOR SWITCH PHASE-NEUTRAL	VOLTMETER SELECTOR SWITCH PHASE-PHASE
P012	12A	P0120019R	P0120020R	P0120021R
P016	16A	P0160019R	P0160020R	P0160021R
P020	20A	P0200019R	P0200020R	P0200021R



12-16-20A

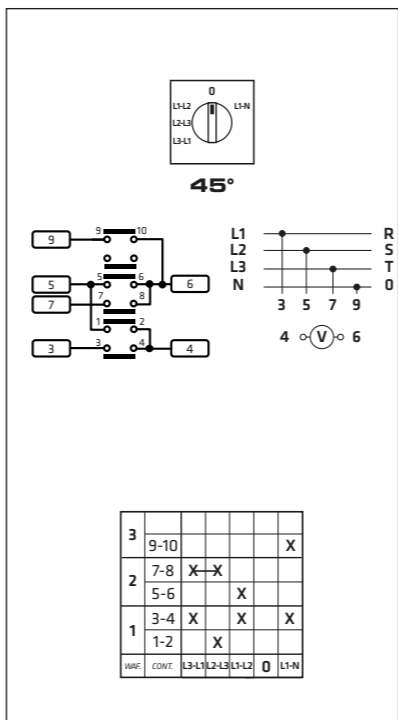
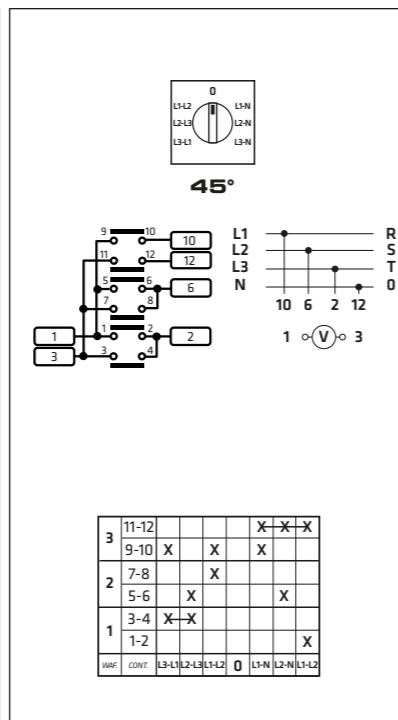
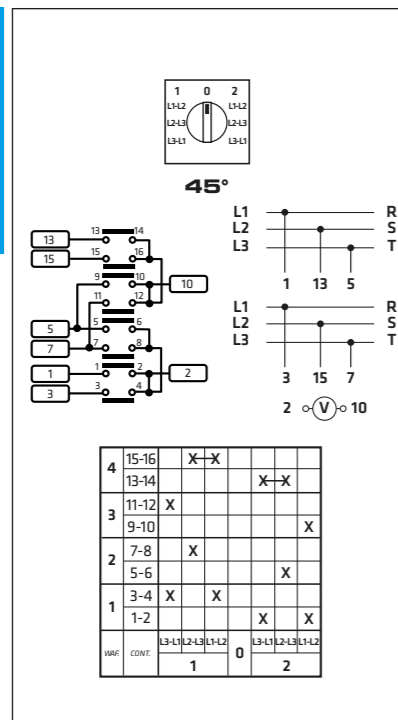

SERIES	AC21A	VOLTMETER SELECTOR SWITCH PHASE-PHASE FOR TWO CIRCUITS	VOLTMETER SELECTOR SWITCH PHASE-PHASE AND PHASE-NEUTRAL	VOLTMETER SELECTOR SWITCH PHASE-PHASE AND 1 PHASE-NEUTRAL
P012	12A	P0120022R	P0120023R	P0120024R
P016	16A	P0160022R	P0160023R	P0160024R
P020	20A	P0200022R	P0200023R	P0200024R

ACTUATOR	FIXING	P012 - P016 - P020						
		90°	45°	45°	45°	45°	45°	NO
	screw	001/0019	001/0020	001/0021	001/0022	001/0023	001/0024	-
	ø22	056X/0019	056X/0020	056X/0021	056X/0022	056X/0023	056X/0024	-
	screw	-	-	-	-	-	-	-
	ø22	-	-	-	-	-	-	-
	screw	-	-	-	-	-	-	-
	ø22	-	-	-	-	-	-	-
	screw	-	-	-	-	-	-	-
	ø22	-	-	-	-	-	-	-
	screw	-	-	-	-	-	-	-
	ø22	-	-	-	-	-	-	-
	screw	-	-	-	-	-	-	-
	ø22	-	-	-	-	-	-	-
	screw	-	-	-	-	-	-	-
	ø22	-	-	-	-	-	-	-
	screw	-	-	-	-	-	-	028X
	ø22	-	-	-	-	-	-	028X
	screw	-	-	-	-	-	-	029X
	ø22	-	-	-	-	-	-	029X



REAR PANEL MOUNTING

PROTECTION CLASS EN60529 - IP65 UL50 NEMA TYPE 1-4-4X-12

<p>12-16-20A</p>	<p>25-32-40A</p>	<p>63-80A</p>	<p>125A</p>	<p>200A</p>																																													
<p>45°</p> <p>60° G125 G200</p> <p>1 2</p> <p>2 4</p> <p>1</p> <table border="1"> <tr><td>1</td><td>3-4</td><td>X</td></tr> <tr><td>1</td><td>1-2</td><td>X</td></tr> <tr><td>NOV. COND.</td><td>1 2</td><td></td></tr> </table>	1	3-4	X	1	1-2	X	NOV. COND.	1 2		<p>45°</p> <p>60° G125 G200</p> <p>1 2</p> <p>2 4</p> <p>1 6 8</p> <p>5</p> <table border="1"> <tr><td>2</td><td>7-8</td><td>X</td></tr> <tr><td>2</td><td>5-6</td><td>X</td></tr> <tr><td>1</td><td>3-4</td><td>X</td></tr> <tr><td>1</td><td>1-2</td><td>X</td></tr> <tr><td>NOV. COND.</td><td>1 2</td><td></td></tr> </table>	2	7-8	X	2	5-6	X	1	3-4	X	1	1-2	X	NOV. COND.	1 2		<p>45°</p> <p>60° G125 G200</p> <p>1 2</p> <p>2 4</p> <p>1 6 8</p> <p>5 10 12</p> <p>9</p> <table border="1"> <tr><td>3</td><td>11-12</td><td>X</td></tr> <tr><td>3</td><td>9-10</td><td>X</td></tr> <tr><td>2</td><td>7-8</td><td>X</td></tr> <tr><td>2</td><td>5-6</td><td>X</td></tr> <tr><td>1</td><td>3-4</td><td>X</td></tr> <tr><td>1</td><td>1-2</td><td>X</td></tr> <tr><td>NOV. COND.</td><td>1 2</td><td></td></tr> </table>	3	11-12	X	3	9-10	X	2	7-8	X	2	5-6	X	1	3-4	X	1	1-2	X	NOV. COND.	1 2			
1	3-4	X																																															
1	1-2	X																																															
NOV. COND.	1 2																																																
2	7-8	X																																															
2	5-6	X																																															
1	3-4	X																																															
1	1-2	X																																															
NOV. COND.	1 2																																																
3	11-12	X																																															
3	9-10	X																																															
2	7-8	X																																															
2	5-6	X																																															
1	3-4	X																																															
1	1-2	X																																															
NOV. COND.	1 2																																																

SERIES	AC21A	1 POLE	2 POLES	3 POLES
P012	12A	P0120025R	P0120026R	P0120027R
P016	16A	P0160025R	P0160026R	P0160027R
P020	20A	P0200025R	P0200026R	P0200027R
C025	25A	C0250025R	C0250026R	C0250027R
C032	32A	C0320025R	C0320026R	C0320027R
C040	40A	C0400025R	C0400026R	C0400027R
C063	63A	C0630025R	C0630026R	C0630027R
C080	80A	C0800025R	C0800026R	C0800027R
G125	125A	G1250025R	G1250026R	G1250027R
G200	200A	G2000025R	G2000026R	G2000027R

ACTUATOR	FIXING	P012 - P016 - P020	C025 C032 C040	C063 C080	G125	G200
		45°	NO	45°	45°	60°
		45°	NO	45°	60°	60°
	screw	001/0025	-	007/0025	201/0025	441/0025
	ø22	056X/0025	-	-	-	-
	screw	-	-	-	-	-
	ø22	-	-	-	-	-
	screw	-	-	-	-	-
	ø22	-	-	-	-	-
	screw	-	-	-	-	-
	ø22	-	-	-	-	-
	screw	-	-	-	-	-
	ø22	-	-	-	-	-
	ø22	-	-	-	-	-
	ø22	-	028X	-	-	-
	ø22	-	029X	-	-	-

▲ Key removable at 0° and 180°

REAR PANEL MOUNTING

PROTECTION CLASS EN60529 - IP65 UL50 NEMA TYPE 1-4-4X-12



12-16-20A

25-32-40A

63-80A

125A

200A

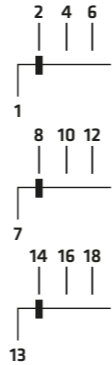
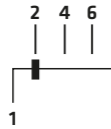
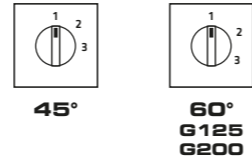
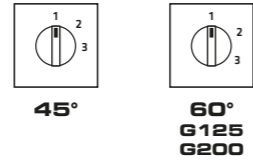
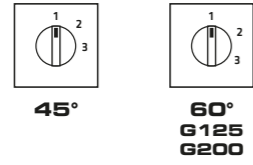

2	5-6			X
1	3-4	X		
	1-2	X		
NOV. CONT.	1	2	3	

3	11-12			X
2	7-8	X		
	5-6		X	
1	3-4	X		
	1-2	X		
NOV. CONT.	1	2	3	

5	17-18			X
4	15-16	X		
	13-14	X		
3	11-12		X	
	9-10		X	
2	7-8	X		
	5-6		X	
1	3-4	X		
	1-2	X		
NOV. CONT.	1	2	3	

SERIES	AC21A	1 POLE	2 POLES	3 POLES
P012	12A	P0120038R	P0120039R	P0120040R
P016	16A	P0160038R	P0160039R	P0160040R
P020	20A	P0200038R	P0200039R	P0200040R
C025	25A	C0250038R	C0250039R	C0250040R
C032	32A	C0320038R	C0320039R	C0320040R
C040	40A	C0400038R	C0400039R	C0400040R
C063	63A	C0630038R	C0630039R	C0630040R
C080	80A	C0800038R	C0800039R	C0800040R
G125	125A	G1250038R	G1250039R	G1250040R
G200	200A	G2000038R	G2000039R	G2000040R

ACTUATOR	FIXING	P012 - P016 - P020	C025 C032 C040	C063 C080	G125	G200
		45°	NO	45°	45°	60°
	screw	001/0038	-	007/0038	201/0038	441/0038
	ø22	056X/0038	-	-	-	-
	screw	-	-	-	-	-
	ø22	-	-	-	-	-
	screw	-	-	-	-	-
	ø22	-	-	-	-	-
	screw	-	-	-	-	-
	ø22	-	-	-	-	-
	screw	-	-	-	-	-
	ø22	-	-	-	-	-
	ø22	-	-	-	-	-
	ø22	-	028X	-	-	-
	ø22	-	029X	-	-	-



REAR PANEL MOUNTING

PROTECTION CLASS EN60529 - IP65 UL50 NEMA TYPE 1-4-4X-12



12-16-20A

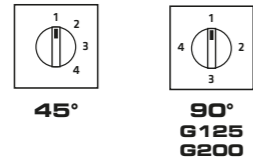

25-32-40A

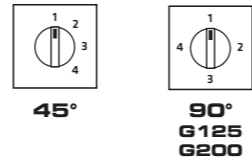
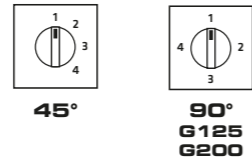

125A

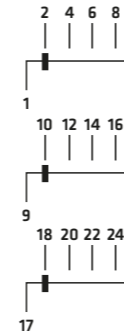
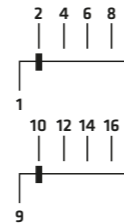
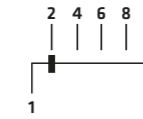

4	15-16			X	
3	13-14		X		
3	11-12	X			
2	9-10	X			
2	7-8		X		
1	5-6		X		
1	3-4	X			
1	1-2	X			
WAMP	CONT.	1	2	3	4

6	23-24			X	
5	21-22	X			
5	19-20	X			
4	17-18	X			
4	15-16		X		
3	13-14		X		
3	11-12	X			
2	9-10	X			
2	7-8		X		
1	5-6		X		
1	3-4	X			
1	1-2	X			
WAMP	CONT.	1	2	3	4



200A

2	7-8			X	
1	5-6		X		
1	3-4	X			
1	1-2	X			
WAMP	CONT.	1	2	3	4

SERIES	AC21A	1 POLE	2 POLES	3 POLES
P012	12A	P0120041R	P0120042R	P0120043R
P016	16A	P0160041R	P0160042R	P0160043R
P020	20A	P0200041R	P0200042R	P0200043R
C025	25A	C0250041R	C0250042R	C0250043R
C032	32A	C0320041R	C0320042R	C0320043R
C040	40A	C0400041R	C0400042R	C0400043R
C063	63A	-	-	-
C080	80A	-	-	-
G125	125A	G1250041R	G1250042R	G1250043R
G200	200A	G2000041R	G2000042R	G2000043R

ACTUATOR	FIXING	P012 - P016 - P020	C025 C032 C040	C063 C080	G125	G200
		45°	NO	45°	90°	90°
	screw	001/0041	-	007/0041	-	441/0041
	ø22	056X/0041	-	-	-	-
	screw	-	-	-	-	-
	ø22	-	-	-	-	-
	screw	-	-	-	-	-
	ø22	-	-	-	-	-
	screw	-	-	-	-	-
	ø22	-	-	-	-	-
	screw	-	-	-	-	-
	ø22	-	-	-	-	-
	ø22	-	-	-	-	-
	ø22	-	-	-	-	-
	ø22	-	-	-	-	-
	ø22	-	-	-	-	-
	ø22	-	-	-	-	-
	ø22	-	-	-	-	-
	ø22	-	-	-	-	-
	ø22	-	-	-	-	-
	ø22	-	-	-	-	-
	ø22	-	-	-	-	-
	ø22	-	-	-	-	-
	ø22	-	-	-	-	-
	ø22	-	-	-	-	-
	ø22	-	-	-	-	-
	ø22	-	-	-	-	-
	ø22	-	-	-	-	-
	ø22	-	-	-	-	-
	ø22	-	-	-	-	-
	ø22	-	-	-	-	-
	ø22	-	-	-	-	-
	ø22	-	-	-	-	-
	ø22	-	-	-	-	-
	ø22	-	-	-	-	-
	ø22	-	-	-	-	-
	ø22	-	-	-	-	-
	ø22	-	-	-	-	-
	ø22	-	-	-	-	-
	ø22	-	-	-	-	-
	ø22	-	-	-	-	-
	ø22	-	-	-	-	-
	ø22	-	-	-	-	-
	ø22	-	-	-	-	-
	ø22	-	-	-	-	-
	ø22	-	-	-	-	-
	ø22	-	-	-	-	-
	ø22	-	-	-	-	-
	ø22	-	-	-	-	-
	ø22	-	-	-	-	-
	ø22	-	-	-	-	-
	ø22	-	-	-	-	-
	ø22	-	-	-	-	-
	ø22	-	-	-	-	-
	ø22	-	-	-	-	-
	ø22	-	-	-	-	-
	ø22	-	-	-	-	-
	ø22	-	-	-	-	-
	ø22	-	-	-	-	-
	ø22	-	-	-	-	-
	ø22	-	-	-	-	-
	ø22	-	-	-	-	-
	ø22	-	-	-	-	-
	ø22	-	-	-	-	-
	ø22	-	-	-	-	-
	ø22	-	-	-	-	-
	ø22	-	-	-	-	-
	ø22	-	-	-	-	-
	ø22	-	-	-	-	-
	ø22	-	-	-	-	-
	ø22	-	-	-	-	-
	ø22	-	-	-	-	-
	ø22	-	-	-	-	-
	ø22	-	-	-	-	-
	ø22	-	-	-	-	-
	ø22	-	-	-	-	-
	ø22	-	-	-	-	-
	ø22	-	-	-	-	-
	ø22	-	-	-	-	-
	ø22	-	-	-	-	-
	ø22	-	-	-	-	-
	ø22	-	-	-	-	-
	ø22	-	-	-	-	-
	ø22	-	-	-	-	-
	ø22	-	-	-	-	-
	ø22	-	-	-	-	-
	ø22	-	-	-	-	-
	ø22	-	-	-	-	-
	ø22	-	-	-	-	-
	ø22	-	-	-	-	-
	ø22	-	-	-	-	-
	ø22	-	-	-	-	-
	ø22	-	-	-	-	-
	ø22	-	-	-	-	-
	ø22	-	-	-	-	-
	ø22	-	-	-	-	-
	ø22	-	-	-	-	-
	ø22	-	-	-	-	-
	ø22	-	-	-	-	-
	ø22	-	-	-	-	-
	ø22	-	-	-	-	-
	ø22	-	-	-	-	-
	ø22	-	-	-	-	-
	ø22	-	-	-	-	-
	ø22	-	-	-	-	-
	ø22	-	-	-	-	-
	ø22	-	-	-	-	-



REAR PANEL MOUNTING

PROTECTION CLASS EN60529 - IP65 UL50 NEMA TYPE 1-4-4X-12



12-16-20A

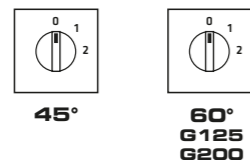

25-32-40A

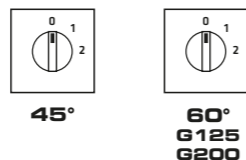

63-80A

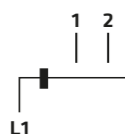

125A

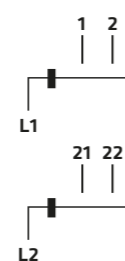

2	7-8		X	
	5-6	X		
1	3-4		X	
	1-2	X		
VAR.	CONT.	0	1	2



200A

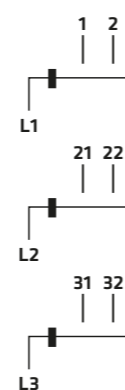
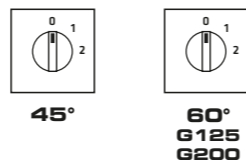

3	11-12		X	
	9-10	X		
2	7-8		X	
	5-6	X		
1	3-4		X	
	1-2	X		
VAR.	CONT.	0	1	2

SERIES	AC2-1A	1 POLE	2 POLES	3 POLES
P012	12A	P0120028R	P0120032R	P0120033R
P016	16A	P0160028R	P0160032R	P0160033R
P020	20A	P0200028R	P0200032R	P0200033R
C025	25A	C0250028R	C0250032R	C0250033R
C032	32A	C0320028R	C0320032R	C0320033R
C040	40A	C0400028R	C0400032R	C0400033R
C063	63A	C0630028R	C0630032R	C0630033R
C080	80A	C0800028R	C0800032R	C0800033R
G125	125A	G1250028R	G1250032R	G1250033R
G200	200A	G2000028R	G2000032R	G2000033R

ACTUATOR	FIXING	P012 - P016 - P020	C025 C032 C040	C063 C080	G125	G200
		45°	NO	45°	45°	60°
	screw	001/0028	-	007/0028	201/0028	441/0028
	ø22	056X/0028	-	-	-	-
	screw	-	-	-	-	-
	ø22	-	-	-	-	-
	screw	-	-	-	-	-
	ø22	-	-	-	-	-
	screw	-	-	-	-	-
	ø22	-	-	-	-	-
	screw	-	-	-	-	-
	ø22	-	-	-	-	-
	screw	-	-	-	-	-
	ø22	-	-	-	-	-
	screw	-	-	-	-	-
	ø22	-	-	-	-	-
	screw	-	-	-	-	-
	ø22	-	-	-	-	-
	screw	-	-	-	-	-
	ø22	-	-	-	-	-
	screw	-	-	-	-	-
	ø22	-	-	-	-	-
	screw	-	-	-	-	-
	ø22	-	028X	-	-	-
	screw	-	-	-	-	-
	ø22	-	029X	-	-	-

REAR PANEL MOUNTING

PROTECTION CLASS EN60529 - IP65 UL50 NEMA TYPE 1-4-4X-12



12-16-20A

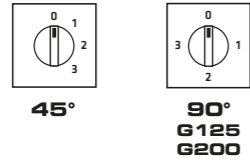

25-32-40A

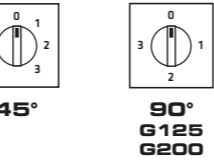
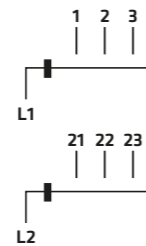
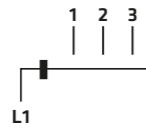
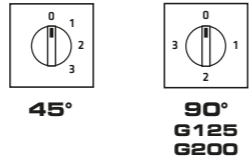

125A

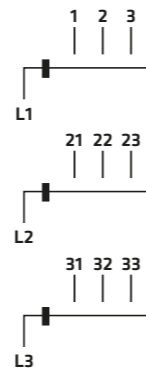

200A



2	7-8			X	
	5-6	X			
1	1-2		X		
WAF	CONT.	0	1	2	3

3	11-12			X	
	9-10	X			
2	7-8		X		
	5-6		X		
1	3-4			X	
	1-2	X			
WAF	CONT.	0	1	2	3

5	19-20			X	
4	15-16			X	
	13-14	X			
3	11-12			X	
	9-10	X			
2	7-8		X		
	5-6		X		
1	3-4			X	
	1-2	X			
WAF	CONT.	0	1	2	3

SERIES	AC21A	1 POLE	2 POLES	3 POLES
P012	12A	P0120029R	P0120034R	P0120035R
P016	16A	P0160029R	P0160034R	P0160035R
P020	20A	P0200029R	P0200034R	P0200035R
C025	25A	C0250029R	C0250034R	C0250035R
C032	32A	C0320029R	C0320034R	C0320035R
C040	40A	C0400029R	C0400034R	C0400035R
C063	63A	-	-	-
C080	80A	-	-	-
G125	125A	G1250029R	G1250034R	G1250035R
G200	200A	G2000029R	G2000034R	G2000035R

ACTUATOR	FIXING	P012 - P016 - P020	C025 C032 C040	C063 C080	G125	G200
		45°	45°	-	90°	90°
	screw	001/0029	007/0029	-	441/0029	461/0029
	ø22	056X/0029	-	-	-	-
	screw	-	-	-	-	-
	ø22	-	-	-	-	-
	screw	-	-	-	-	-
	ø22	-	-	-	-	-
	screw	-	-	-	-	-
	ø22	-	-	-	-	-
	screw	-	-	-	-	-
	ø22	-	-	-	-	-
	ø22	-	028X	-	-	-
	ø22	-	029X	-	-	-



12-16-20A

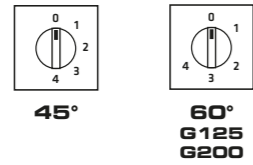

25-32-40A

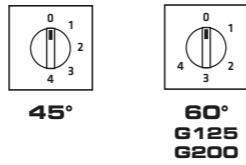

125A

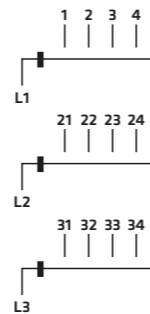
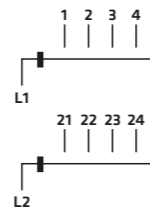
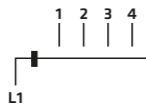

200A

2	7-8			X		
	5-6	X				
1	3-4			X		
	1-2	X				
SWP	CONT.	0	1	2	3	4

4	15-16			X		
	13-14	X				
3	11-12			X		
	9-10	X				
2	7-8			X		
	5-6	X				
1	3-4			X		
	1-2	X				
SWP	CONT.	0	1	2	3	4

6	23-24			X		
	21-22	X				
5	19-20			X		
	17-18	X				
4	15-16			X		
	13-14	X				
3	11-12			X		
	9-10	X				
2	7-8			X		
	5-6	X				
1	3-4			X		
	1-2	X				
SWP	CONT.	0	1	2	3	4

SERIES	AC21A	1 POLE	2 POLES	3 POLES
P012	12A	P0120030R	P0120036R	P0120037R
P016	16A	P0160030R	P0160036R	P0160037R
P020	20A	P0200030R	P0200036R	P0200037R
C025	25A	C0250030R	C0250036R	C0250037R
C032	32A	C0320030R	C0320036R	C0320037R
C040	40A	C0400030R	C0400036R	C0400037R
C063	63A	-	-	-
C080	80A	-	-	-
G125	125A	G1250030R	G1250036R	G1250037R
G200	200A	G2000030R	G2000036R	G2000037R

ACTUATOR	FIXING	P012 - P016 - P020	C025 C032 C040	C063 C080	G125	G200
		45°	NO	45°	60°	60°
	screw	001/0030	-	007/0030	-	441/0030
	ø22	056X/0030	-	-	-	-
	screw	-	-	-	-	-
	ø22	-	-	-	-	-
	screw	-	-	-	-	-
	ø22	-	-	-	-	-
	screw	-	-	-	-	-
	ø22	-	-	-	-	-
	screw	-	-	-	-	-
	ø22	-	-	-	-	-
	ø22	-	-	-	-	-
	ø22	-	-	-	-	-
	ø22	-	-	-	-	-
	ø22	-	028X	-	-	-
	ø22	-	029X	-	-	-



REAR PANEL MOUNTING | ACTUATORS SCREW FIXING

12-16-20A

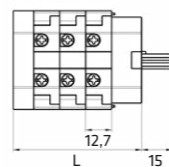
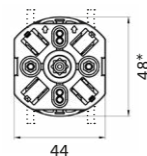

WAFER GAP	L x WAFER N°					
12,7	1	2	3	4	5	6
	37,4	50,1	62,8	75,5	88,2	100,9

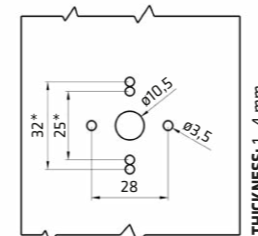

FIXING:
Captive M3 bolt - 28 mm
* ALTERNATIVE FIXING
Screwplast 25 or 32 mm

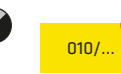
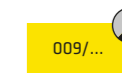
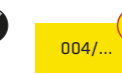
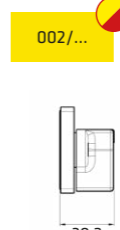
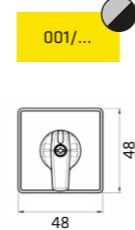

* If cam switch is provided of external bridge (wafer to wafer) the height will be increased of ~ 2 mm for the lower and upper sides.

25-32-40A

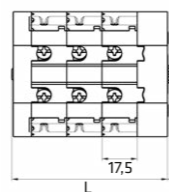
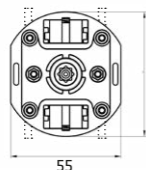

WAFER GAP	L x WAFER N°					
17,5	1	2	3	4	5	6
	42,2	59,7	77,2	94,7	112,2	129,7

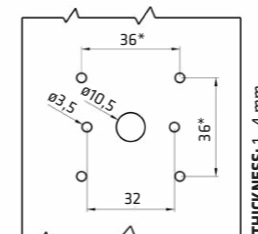

FIXING:
Captive M3 bolt - 32 mm
* ALTERNATIVE FIXING
Screwplast 36 mm

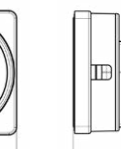
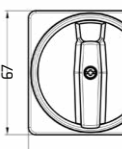
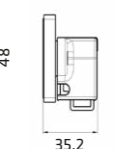
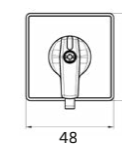
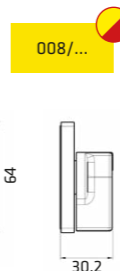
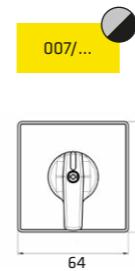

* If cam switch is provided of external bridge (wafer to wafer) the height will be increased of ~ 1 mm for the lower and upper sides.

63-80A

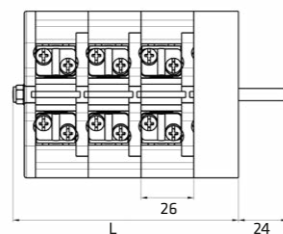
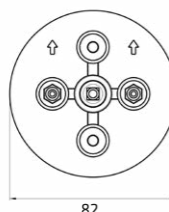

WAFER GAP	L x WAFER N°					
26	1	2	3	4	5	6
	59,1	85,1	111,1	137,1	163	189,1

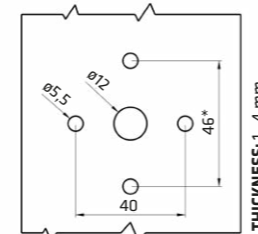

FIXING:
Captive M5 bolt - 40 mm
* ALTERNATIVE FIXING
M5 - 46 mm

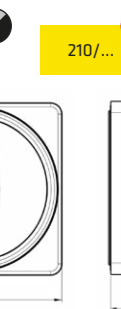
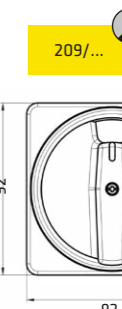
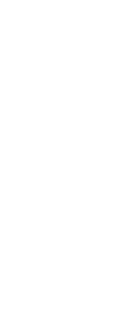
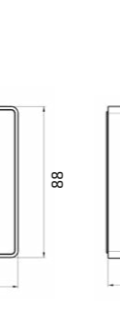
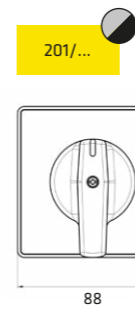

125A

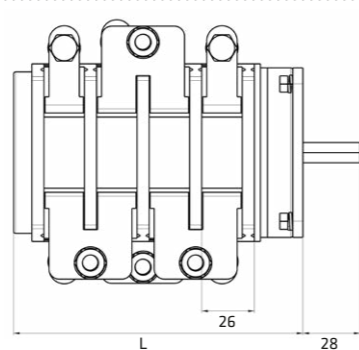
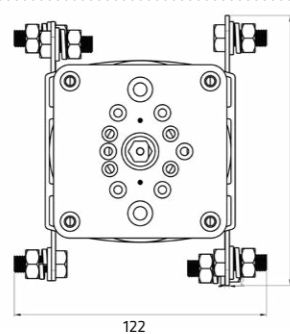

WAFER GAP	L x WAFER N°					
26	1	2	3	4	5	6
	66	92	118	144	170	196

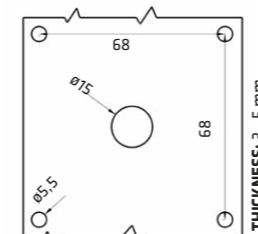

FISSAGGIO:
M5 bolt 68 mm

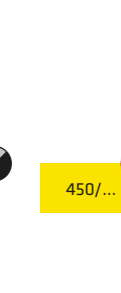
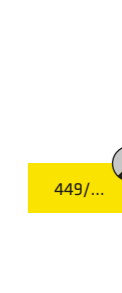
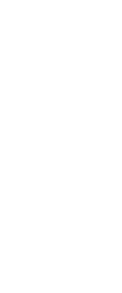
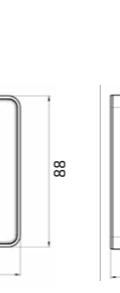

200A

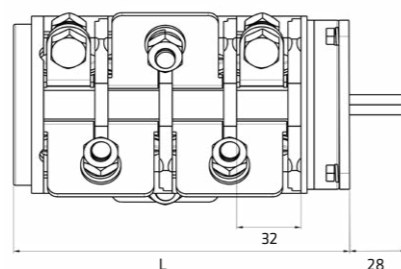
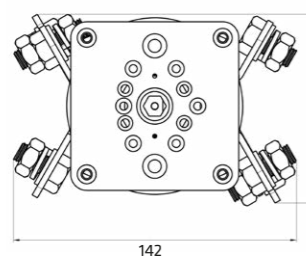

WAFER GAP	L x WAFER N°					
32	1	2	3	4	5	6
	72	104	136	168	200	232

FISSAGGIO:
M5 bolt 68 mm

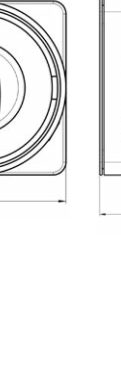
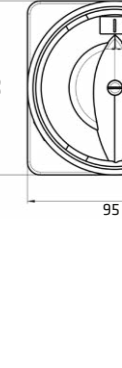
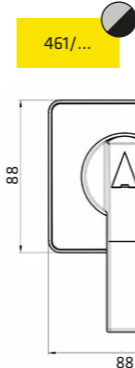



12-16-20A

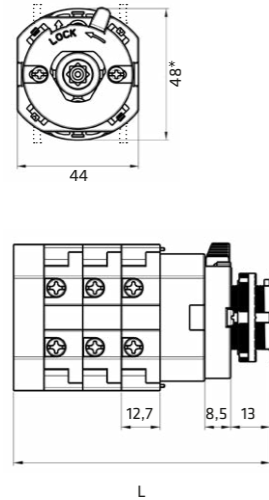

WAFER GAP	PANEL THICKNESS	L x WAFER N°					
		1	2	3	4	5	6
12,7	1 mm	57,9	70,6	83,3	96	108,7	121,4
	2 mm	56,9	69,6	82,3	95	107,7	120,4
	3 mm	55,9	68,6	81,3	94	106,7	119,4
	4 mm	54,9	67,6	80,3	93	105,7	118,4
	5 mm	53,9	66,6	79,3	92	104,7	117,4
	6 mm	52,9	65,6	78,3	91	103,7	116,4

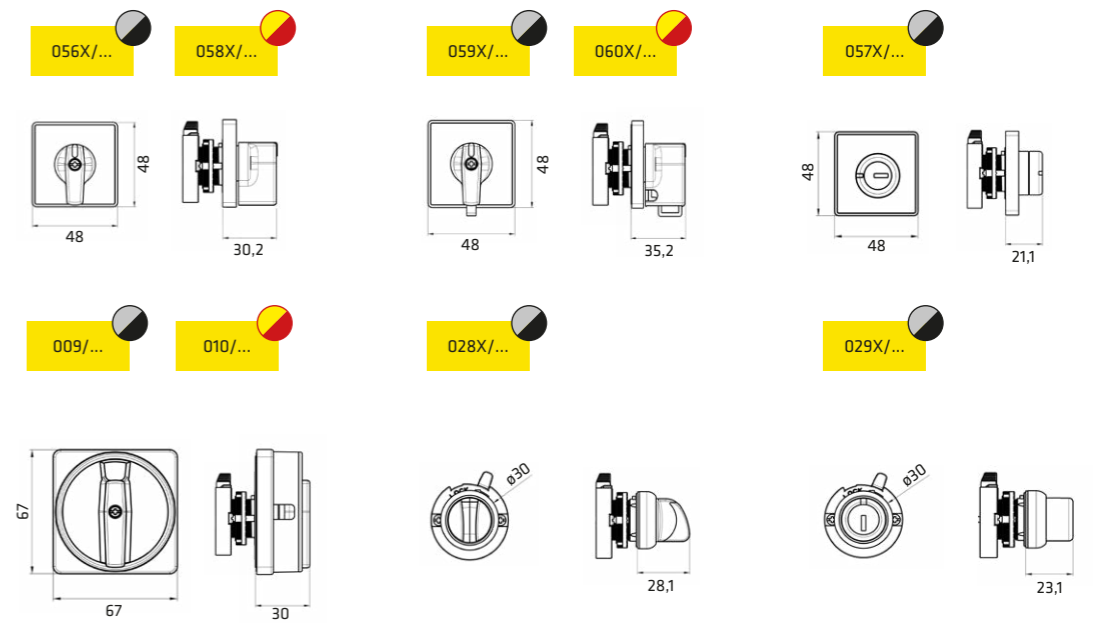
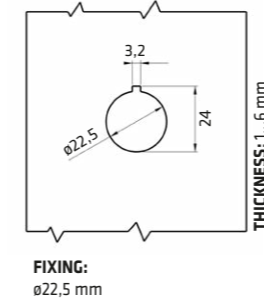

* If cam switch is provided of external bridge (wafer to wafer) the height will be increased of ~ 2 mm for the lower and upper sides.

RANGE OVERVIEW AND GENERAL CHARACTERISTICS



COMPLY WITH RULES

IEC 947-3, EN 60947-3, UL508



SERIES		PO12-PO16-PO20 PX12-PX16-PX20	C025-C032-C040 CX25-CX32-CX40		
Protection class	control EN 60529 (UL50) NEMA 4X control with knob only terminals	IP65 (Type 1 - 4 -4X) IP40 IP20 (PO) - IP10 (PX)	IP65 (Type 1 - 4 -4X) IP40 IP20 (PO) - IP10 (PX)		
Material group	EN 60947-1	II	II		
Pollution grade	EN 60947-1	3	3		
Flammability	UL94	VO (Live Electrical parts)	VO (Live Electrical parts)		
Ambient temperature	°C	Operating: -40 +85 Storage: -40 +70	Operating: -40 +85 Storage: -40 +70		
Climate Withstand	IEC 68 part 2-3 IEC 68 part 2-30	Hot damp Unsettled hot damp	Hot damp Unsettled hot damp		
Terminal screw identification		EN50013	EN50013		
Connections	Terminal block caliber EN60947-1 Terminal screw Screwing torque EN60947-1 UL508	A3 M3,5 0,8 Nm (7,2 lb. in.) 7,5 lb. in. (0,85 Nm)	A5 M4 1,2 Nm (10,6 lb. in.) 12 lb. in. (1,4 Nm)		
Connectable section	Flexible conductors min/max Solid conductors min/max	mm ² AWG mm ² AWG	mm ² AWG mm ² AWG		
Contacts		Double breaking	Double breaking		
Opening angles		30° - 45° - 60° - 90°	30° - 45° - 60° - 90°		
Mechanical lifetime at 120 operations for hour	mil./cl	1 1 1	1 1 1		
Electrical lifetime at 120 operations for hour	mil./cl	1 0,75 0,75	1 0,75 0,75		

CERTIFICATIONS		PO12 PX12	PO16 PX16	PO20 PX20	C025 CX25	C032 CX32	C040 CX40
CE	CE mark - Europe	■	■	■	■	■	■
cUL	cUL Listed - USA and Canada	●	●	●	●	●	●
IMQ	IMQ Istituto Marchio Qualità - Italy	●	●	●	●	●	●
CCC	CCC Cina	●	●	●	●	●	●
EAC	EAC Russia	●	●	●	●	●	●

C063-C080		G125	G200
IP65		IP65	IP65
IP40		-	-
IP00		IP00	IP00
II		IIIA	IIIA
3		3	3
VO (Live Electrical parts)		VO (Live Electrical parts)	VO (Live Electrical parts)
Operating: -40 +70		Operating: -15 +55	Operating: -15 +55
Storage: -40 +70		Storage: -25 +70	Storage: -25 +70
Hot damp		-	-
Unsettled hot damp		-	-
EN50013		-	-
A7		-	-
2xM4		Hex. screw M8 for bars and cable lugs	Hex. screw M10 for bars and cable lugs
1,2 Nm (10,6 lb. in.)		-	-
10,62 lb. in. (1,2 Nm)		-	-
2,5/35		-	-
14 - 3		-	-
2,5/35		-	-
14 - 3		-	-
Double breaking		Double breaking	Double breaking
45° - 60° - 90°		60° - 90°	60° - 90°
1	1	0,1	0,1
0,5	0,25	0,01	0,01

C063	C080	G125	G200
■	■	■	■
●	●	●	●
●	●		

PHOENIX CAM SWITCHES
PHOENIX CAM SWITCHES
ELECTRICAL CHARACTERISTICS

EN 60947-3 CHARACTERISTICS			PO12 - PX12	PO16 - PX16	PO20 - PX20
Rated operating voltage Ue	V		690	690	690
Rated insulation voltage Ui	V		690	690	690
Rated impulse withstand voltage Uimp (sectionable)	kV		4	4	4
Rated thermal current Ith	A		16	20	25
Rated thermal current in enclosed Ithe	A		12	16	20
Frequency	Hz		50/60	50/60	50/60
RATED OPERATING CURRENT Ie: alternate current			PO12 - PX12	PO16 - PX16	PO20 - PX20
AC-21A Switching resistive loads with light overloads	690V A		12	16	20
AC-22A Switching mixed resistive and inductive loads at light overloads	690V A		12	16	20
AC-23A Periodic switching of motors	single phase - 1 pole	110V A/kW	12/1,1	14/1,5	18/2
		230V A/kW	12/2,2	14/3	18/4
	3 phases - 3 poles	230V A/kW	10/3	14/4	16/5
		400V A/kW	10/5,5	14/7,5	16/9
		500V A/kW	10/7,5	14/10	16/11
AC3 Starting of cage motors (interruption hile running)	single phase - 2 poles	110V A/kW	10/0,75	12/1,1	16/1,5
		230V A/kW	10/2	12/2,2	16/3,5
	3 phases - 3 poles	230V A/kW	8/2,2	10/3	12/4
		400V A/kW	8/4	10/5	12/6
		500V A/kW	8/5,5	10/7,5	12/8
Nominal interruption power AC-23A (cosφ 0,45)	230V A	690V A/kW	6/5,5	8/7,5	10/9
		400V A	80	104	128
		500V A	80	112	128
		690V A	80	112	128
Power dissipation for each pole	W		0,3*	0,35*	0,4*
RATED OPERATING CURRENT Ie: direct current			PO12 - PX12	PO16 - PX16	PO20 - PX20
DC-21A Switching resistive loads with light overloads	50V (1 phase) A		10	12	16
DC-22A Switching mixed resistive and inductive loads at light overloads	30V (1 phase) A		8	10	12
SHORT CIRCUIT CHARACTERISTICS			PO12 - PX12	PO16 - PX16	PO20 - PX20
Rated short-time short circuit withstand current Icw (1 s)	A		300	300	300
Rated short circuit making capacity Icm	A		1200	1200	1200
Conditional rated short circuit withstand current	kA		5	5	5
Fuse rating gG	690V A		20	20	20
UL 508 CHARACTERISTICS			PO12 - PX12	PO16 - PX16	PO20 - PX20
General Use	600V AC A		12	16	20
Standard motor load	single phase - 2 poles	120V AC HP (FLA)	0,5 (9,8)	1 (16)	1,5 (20)
		240V AC HP (FLA)	1 (8)	1,5 (10)	2 (12)
	3 phases - 3 poles	200V AC HP (FLA)	1,5 (6,9)	3 (11,04)	5 (17,5)
		240V AC HP (FLA)	3 (9,6)	5 (15,2)	5 (15,2)
		480V AC HP (FLA)	5 (7,6)	7,5 (11)	10 (14)
		600V AC HP (FLA)	5 (6,1)	7,5 (9)	10 (11)

CO25 - CX25	CO32 - CX32	CO40 - CX40	CO63	CO80	G125	G200
690	690	690	690	690	690	690
690	690	690	690	690	690	690
6	6	6	8	8	6	6
32	40	50	85	100	150	225
25	32	40	85	100	150	225
50/60	50/60	50/60	50/60	50/60	50/60	50/60
CO25 - CX25	CO32 - CX32	CO40 - CX40	CO63	CO80	G125	G200
25	32	40	63	80	125	200
25	32	40	63	80	125	200
25/1,5	30/2,2	35/3	45/4	63/5,5	-	-
25/4	30/5,5	35/6,5	45/7,5	63/11	-	-
25/7,5	30/9	35/11	50/15	58/18,5	140/45	169/55
22/11	24/15	32/18,5	40/22	54/30	78/45 (415V)	95/55 (415V)
22/11	27/18,5	32/22	40/30	54/37	65/45	79/55
20/15	22/18,5	25/22	32/30	40/37	47/45	57/55
22/1,1	25/1,5	30/2,5	36/3,7	45/4	-	-
22/3,7	25/4	30/5,5	36/6,5	45/7,5	-	-
18/5,5	23/7,5	27/9	37/11	47/15	115/37	140/45
18/7,5	23/11	27/15	35/18,5	44/22	64/37 (415V)	78/45 (415V)
18/11	23/15	27/18,5	35/22	44/30	53/37	64/45
14/11	18/15	20/18,5	25/22	32/30	39/37	47/45
200	240	280	400	464	-	-
176	216	256	320	432	-	-
176	216	256	320	432	-	-
160	176	200	256	320	-	-
-	-	-	-	-	-	-
CO25 - CX25	CO32 - CX32	CO40 - CX40	CO63	CO80	G125	G200
20 ▼	25 ▼	32 ▼	-	-	-	-
16 ▼	20 ▼	25 ▼	-	-	-	-
CO25 - CX25	CO32 - CX32	CO40 - CX40	CO63	CO80	G125	G200
500	500	500	1200	1200	-	-
2840	2840	2840	2000	2000	-	-
10	10	10	10	10	20	20
40 ■	40 ■	40 ■	100	100	125 ▲	200 ▲
CO25 - CX25	CO32 - CX32	CO40 - CX40	CO63	CO80	G125	G200
25	32	40	63	85	125	175
1,5 (20)	2 (24)	3 (34)	5 (56)	5 (56)	-	-
3 (17)	5 (28)	5 (28)	7,5 (40)	10 (50)	-	-
7,5 (25,3)	7,5 (25,3)	10 (32,2)	-	-	10 (56)	15 (84)
7,5 (22)	7,5 (22)	10 (28)	15 (42)	20 (54)	20 (54)	25 (68)
15 (21)	20 (27)	20 (27)	30 (40)	40 (52)	40 (52)	50 (65)
15 (17)	20 (22)	20 (22)	40 (41)	50 (52)	50 (52)	50 (52)

EXECUTION ON DEMAND

ORDER FORM FOR SPECIAL SCHEME ON REQUEST

SPECIAL SHAFTS

- Length and shape on request.



FAST ON CONNECTIONS

- Flat fast on terminals.
- Single or double terminals.
- P012 ... P020 - C025 ... C040 Series.



AXIAL INTERLOCK

- "Push and turn" interlock in several positions.
- C025 ... C040 Series.



UNDIRECTIONAL ROTATION

- Unidirectional turn.
- C025 ... C040 Series.



PE SERIES - LOWERED CAM SWITCHES

- Only for 12 ... 20A Series.
- Only for few electrical schemes.
- Length 20mm less than an equivalent PO-PX Series.



COAXIAL COUPLING

- Power Unit + Aux Unit.



CAM SWITCH

- Suitable for PCB connection.
- PATENTED** product.

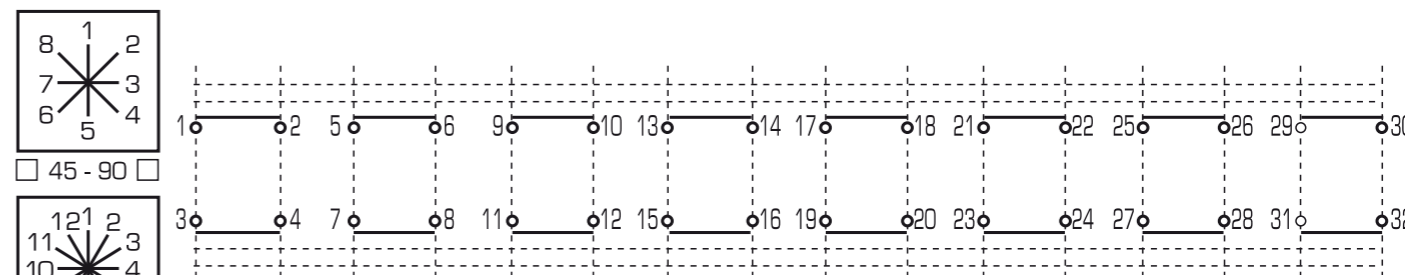
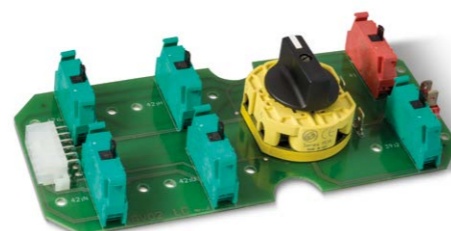

POS.	DESCRIPTION	POS.	DESCRIPTION
1		7	
2		8	
3		9	
4		10	
5		11	
6		12	

WAFER	CONT.	POSITION
10	39-40	
9	37-38	
9	35-36	
9	33-34	
8	31-32	
8	29-30	
7	27-28	
7	25-26	
6	23-24	
6	21-22	
5	19-20	
5	17-18	
4	15-16	
4	13-14	
3	11-12	
3	9-10	
2	7-8	
2	5-6	
1	3-4	
1	1-2	

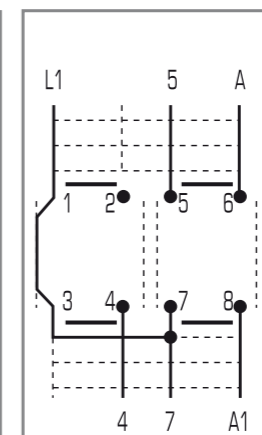

WAFER	CONT.	POSITION
2	7-8	X
2	5-6	X-X
1	3-4	X X
1	1-2	X

- Open Contact
- Closed contact
- Break before make
- Contact closed: no interruption during changeover
- Spring return
- Make before break
- Open contact early make

Rated current Ie		
Operational rated voltage Ue		
Category	Amp/kw	Volt
<input type="checkbox"/> AC-21A	A	V
<input type="checkbox"/> AC-22A	A	V
<input type="checkbox"/> AC-23A	1Ph kW	V
	3Ph kW	V
<input type="checkbox"/> AC-3	1Ph kW	V
	3Ph kW	V

Series _____

Mounting:

Rear Panel mounting

Base

Din

Operating:

Notes:

Company: _____

Contact person: _____

Phone _____

Fax _____

E-mail _____

Quantity _____

Due date _____

Order Nr. _____