

SECURITY PUSHBUTTON SWITCHES • Ø19MM • UP TO 2NO2NC • LED ILLUMINATED

🏆 DISTINCTIVE FEATURES

Great tactile feedback
illuminated versions
selector / key selector versions
momentary or latched
up to 2NO/2NC form C
3A @ 220 V
specific wiring on request
specific marking on request



⚡ ELECTRICAL SPECIFICATIONS

Max voltage : 250 V
Max current/voltage with resistive load :
3 A @ 220Vac / 5A @ 24 Vdc
Initial contact resistance : 50 mΩ max
Insulation resistance : 1 GΩ mini at 500Vdc
Electrical life : 100.000 cycles at full load
Dielectric strength : 1500 VAC, 50Hz, 50 seconds
LED voltage : see Build your part number section,
LED typical life : 40.000 hours

⚙️ ENVIRONMENTAL SPECIFICATIONS

Operating temperature = from -40°C to +70°C
Protection grade to IP67 - frontpanel
Compliant with IEC60947-5-1 standard
Compliant with GB14048.5 standard

⚙️ MECHANICAL SPECIFICATIONS

Actuation force : from 2 to 5 Newtons
Travel : from 1.5mm to 2.5mm
Mechanical life : 1.000.000 cycles
Switchbase material : PA66
Body material : see Build your part number section
Button material : see Build your part number section,
Lugs material : gold plated copper
Contact material : gold plated silver

☰ GENERAL SPECIFICATIONS

Typical drilling diameter : 19.5mm
Panel thickness : 20mm max.
Minimum pitch for matrix installation : 24 x 24 mm
Hand soldering : 300°C max. during 5 seconds



SOAV3 series

SECURITY PUSHBUTTON SWITCHES • Ø19MM • UP TO 2NO2NC • LED ILLUMINATED

BUILD YOUR PART NUMBER

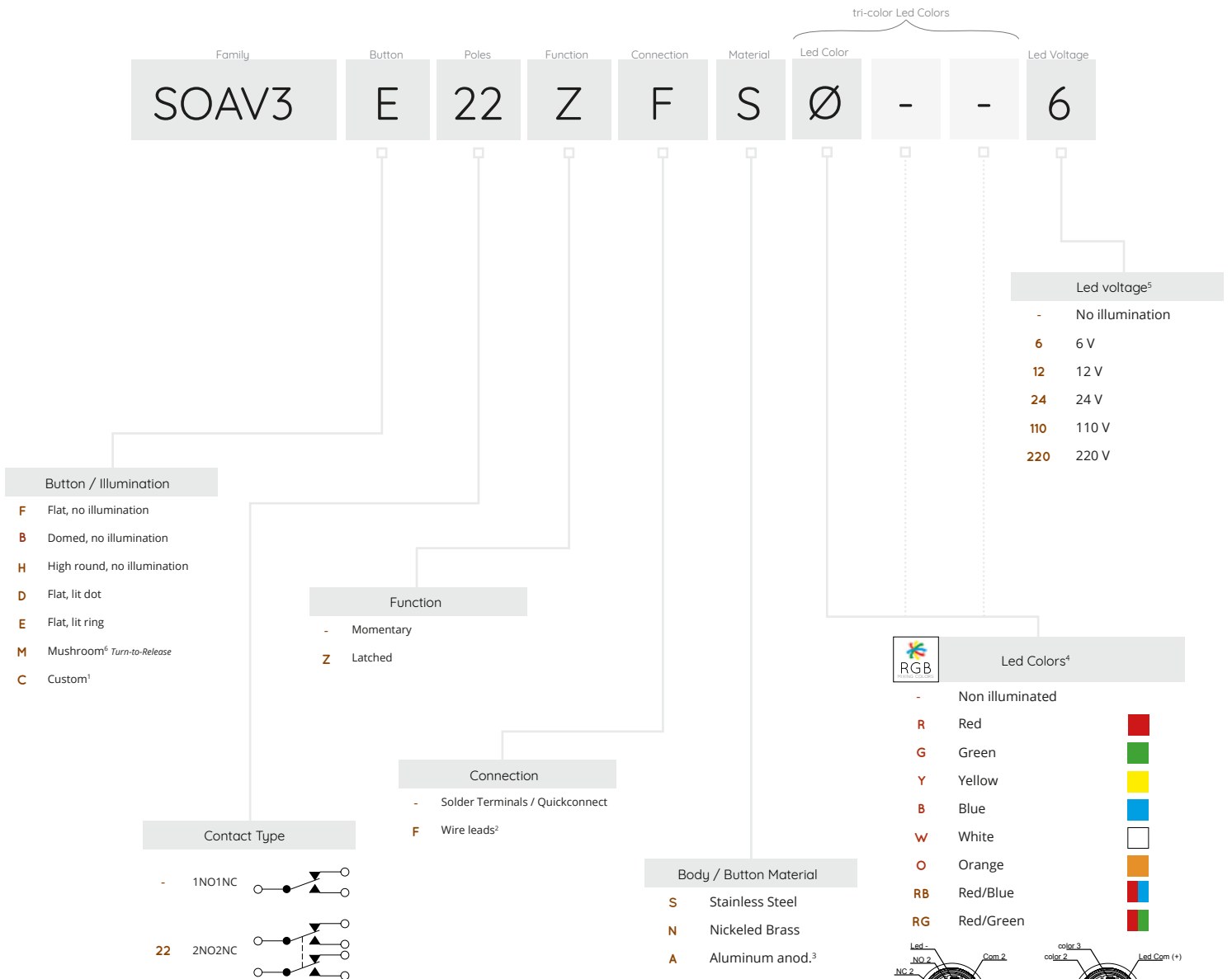

ABOUT THIS RANGE

¹  U.DESIGN service: custom button design, custom marking, **custom illuminated logo** on request

²  U.DESIGN service: custom wiring and harness upon request.

³ Anodized aluminum with custom color upon request and subject to MOQ.

⁴ Led Colors :

- for 1 or 2 colors version, please select colors from the list. For bi-color Leds (RG or RB), color change is operated with LED polarity swapping.

- for 3 colors, **1NO1NC version only**, select 3 desired colors from the list. Common power supply is made through the Cathod.

- **High intensity LED available on request**

⁵ Built-in protection resistor. Other LED voltages possible upon request.

⁶ Mushroom version available with simple or double pole, no illumination : **part numbers SOAV3MZS and SOAV3M2ZS only.**

Our pushbutton switches are delivered with their nickel plated brass hex nuts as well as their gasket.

⚠ SOME CONFIGURATIONS MIGHT NOT BE AVAILABLE OR SUBMITTED TO M.O.Q.

FOR ALL YOUR CUSTOM REQUESTS, CONTACT US !
sales@hynoppe.com

SOAV3 series

SECURITY PUSHBUTTON SWITCHES • Ø19MM • UP TO 2NO/2NC • LED ILLUMINATED

CONFIGURATION EXAMPLES

FLAT BUTTON - NO ILLUMINATION - 2NO/2NC



SOAV3F22S

stainless steel, momentary

SOAV3F22ZS

stainless steel, maintained

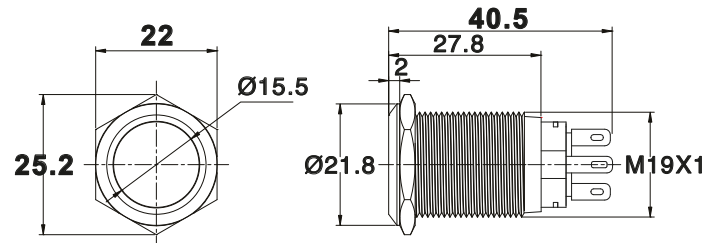

FLAT BUTTON - "STAND-BY" ILLUMINATED LOGO- 1NO/1NC



SOAV3KS

stainless steel, momentary

SOAV3KZS

stainless steel, maintained

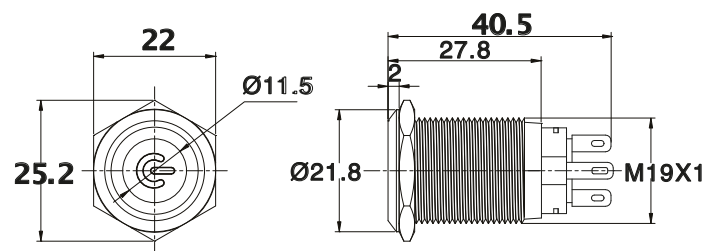

FLAT BUTTON - ILLUMINATED RING - 1NO/1NC



SOAV3ES••

stainless steel, momentary

SOAV3EZS••

stainless steel, maintained

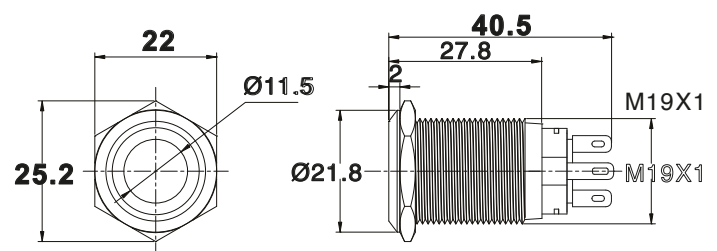

* please choose LED color and voltage in Build your part number section

FLAT BUTTON - ILLUMINATED DOT - 1NO/1NC



SOAV3DS••

stainless steel, momentary

SOAV3DZS••

stainless steel, maintained

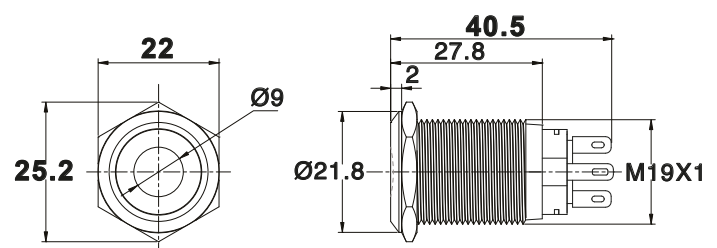

* please choose LED color and voltage in Build your part number section

SOAV3 series

SECURITY PUSHBUTTON SWITCHES • Ø19MM • UP TO 2NO2NC • LED ILLUMINATED

HIGH ROUND BUTTON - ILLUMINATED RING - 2NO/2NC



SOAV3J22ZS••

stainless steel, maintained

* please choose LED color and voltage in Build your part number section

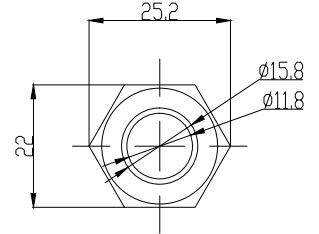
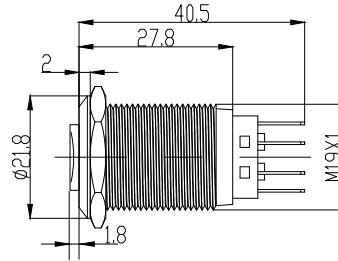

MUSHROOM - 1NO/1NC



SOAV3MZS

stainless steel, maintained

Ø24.2

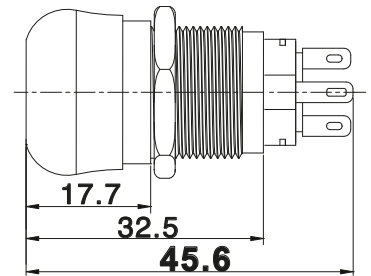
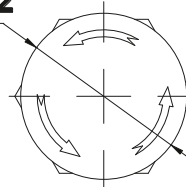

ACCESSORIES

QUICK CONNECTOR



		SOAV3	
		1 NO1NC	2NO2NC
LED colors	No ILLUMINATION	SOAC3-3P-15	SOAC3-6P-15
		SOAC3-5P-15	SOAC3-8P-15
		SOAC3-8P-15	N/A

SOAC3-C : empty connector / SOAC3-M : 2.8 crimping terminal for SOAC3-C



U.DESIGN

cablage haute couture



Custom designed wiring
MOQ required

Illuminated customized logo
MOQ required
no technical fees



SOAV3 series

SELECTORS & BUZZERS • Ø19MM • UP TO 2NO2NC • LED ILLUMINATED

BUILD YOUR PART NUMBER - SELECTORS & BUZZERS

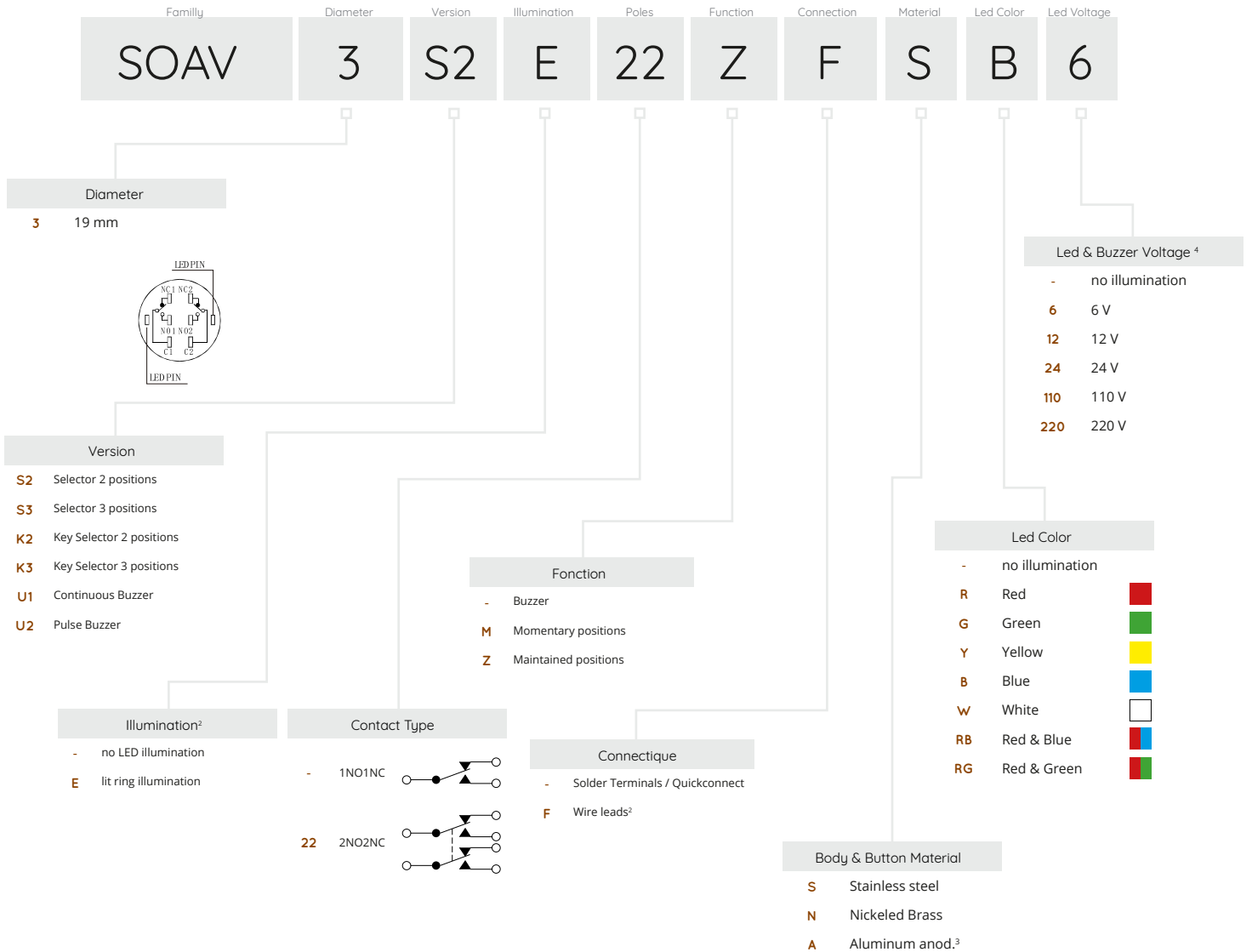

ABOUT THIS RANGE

¹ Key selector available without illumination only.

² service  U.DESIGN : custom wiring and harness upon request.

³ Anodized aluminum with custom color upon request and subject to MOQ.

⁴ Built-in protection resistor. Other LED voltages possible upon request.

Our pushbutton switches are delivered with their nickel plated brass hex nuts as well as their gasket.

FOR ALL YOUR SPECIFIC
REQUESTS, PLEASE WRITE :
SALES@KYNOPPE.COM

SOAV3 series

SELECTORS & BUZZERS • Ø19MM • UP TO 2NO2NC • LED ILLUMINATED

CONFIGURATION EXAMPLES

2 POSITIONS SELECTOR - NO ILLUMINATION - SPDT



SOAV3S2MS

stainless steel, 2 positions momentary
90°, single pole

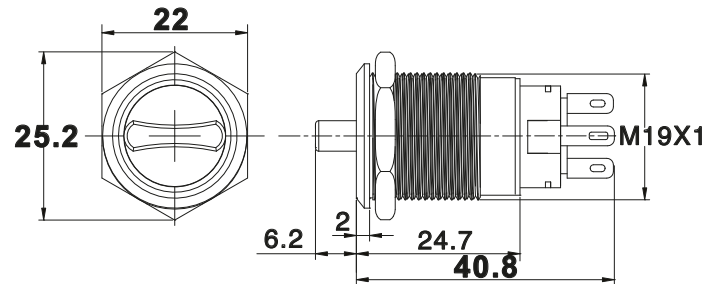

3 POSITIONS SELECTOR - RING ILLUMINATION - DPDT



SOAV3S3E22ZS••

stainless steel, 3 positions maintained
90°, double pole

* please select LED color as well as voltage in Build Your Part Number section

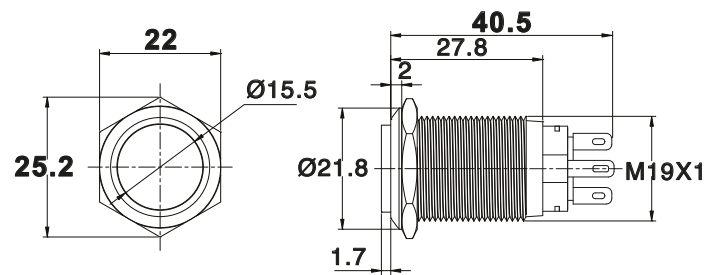

3 POSITIONS KEY SELECTOR - NO ILLUMINATION - SPDT



SOAV3K3ZS

stainless steel, 3 positions maintained
90°

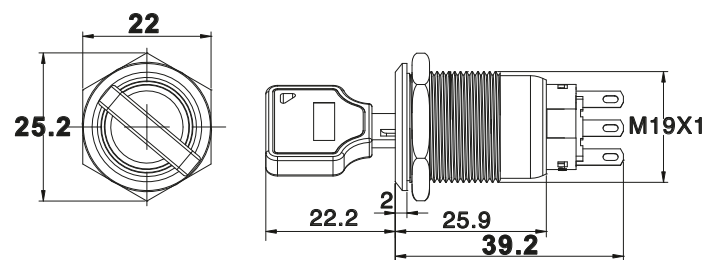

PULSE BUZZER - RING ILLUMINATION



SOAV3U2ES••

stainless steel

* please select LED color as well as voltage in Build Your Part Number section

