



**GIOVENZANA**  
INTERNATIONAL B.V.



**GIOVENZANA**  
INTERNATIONAL B.V.



**AUXILIARY CONTROLS**  
**NEMA SERIES**

**AUXILIARY CONTROLS | NEMA SERIES**

**AUXILIARY CONTROLS | NEMA SERIES**

**PUSH BUTTONS Ø22 | WITH COLOUR CAP | NEMA 4-4X**

MOMENTARY



TYPE	COLOUR INDEX	CODE	WEIGHT grams	MIN. PACK QUANTITY	SIZES
FLUSH PUSH BUTTON	■	PPRN1GL4X	30	10	
	■	PPRN2GL4X	30	10	
	■	PPRN3GL4X	30	10	
	■	PPRN4GL4X	30	10	
	■	PPRN5GL4X	30	10	
	■	PPRN8GL4X	30	10	



TYPE	COLOUR INDEX	CODE	WEIGHT grams	MIN. PACK QUANTITY	SIZES
EXTENDED PUSH BUTTON	■	PPSN1GL4X	31	10	
	■	PPSN2GL4X	31	10	
	■	PPSN3GL4X	31	10	
	■	PPSN4GL4X	31	10	
	■	PPSN5GL4X	31	10	
	■	PPSN8GL4X	31	10	

**PUSH BUTTONS Ø22 | WITH LENS CAP**

MOMENTARY



TYPE	COLOUR INDEX	CODE	WEIGHT grams	MIN. PACK QUANTITY	SIZES
FLUSH PUSH BUTTON	■	PPRL1GL4X	30	10	
	■	PPRL2GL4X	30	10	
	■	PPRL3GL4X	30	10	
	■	PPRL4GL4X	30	10	
	■	PPRL5GL4X	30	10	



TYPE	COLOUR INDEX	CODE	WEIGHT grams	MIN. PACK QUANTITY	SIZES
EXTENDED PUSH BUTTON	■	PPSL1GL4X	31	10	
	■	PPSL2GL4X	31	10	
	■	PPSL3GL4X	31	10	
	■	PPSL4GL4X	31	10	
	■	PPSL5GL4X	31	10	

**MULTIFUNCTION PUSH BUTTONS Ø22 | NOT LIGHT | NEMA 4-4X**



TYPE	COLOUR INDEX	CODE	WEIGHT grams	MIN. PACK QUANTITY	SIZES
DUAL PUSH BUTTON	■	PPDNGL4X	38	10	



TYPE	COLOUR INDEX	CODE	WEIGHT grams	MIN. PACK QUANTITY	SIZES
EXTENDED DUAL PUSH BUTTON	■	PPDNSGL4X	38	10	



TYPE	COLOUR INDEX	CODE	WEIGHT grams	MIN. PACK QUANTITY	SIZES
MULTIFUNCTION PUSH BUTTON	■	PPMNSGL4X	40	10	

**MULTIFUNCTION PUSH BUTTONS Ø22 | LIGHT | NEMA 4-4X**



TYPE	COLOUR INDEX	CODE	WEIGHT grams	MIN. PACK QUANTITY	SIZES
DUAL PUSH BUTTON	■	PPDLGL4X	38	10	
	■	PPDLGL4X.1	38	10	



TYPE	COLOUR INDEX	CODE	WEIGHT grams	MIN. PACK QUANTITY	SIZES
EXTENDED DUAL PUSH BUTTON	■	PPDLSGL4X	38	10	



**AUXILIARY CONTROLS | NEMA SERIES**

**AUXILIARY CONTROLS | NEMA SERIES**

**EMERGENCY PUSH BUTTONS Ø22 | EN ISO 13850 | NEMA 4-4X**

	TYPE	COLOUR INDEX	CODE	WEIGHT grams	MIN. PACK QUANTITY	SIZES
	MUSHROOM OPERATOR Ø30 TWIST TO RELEASE	■	PPFN1R3N4X	42	10	
	MUSHROOM OPERATOR WITH VISION Ø30 TWIST TO RELEASE	■	PPFN1R3S4X	44	10	

**EMERGENCY PUSH BUTTONS Ø22 | EN ISO 13850 | NEMA 4-4X**

	TYPE	COLOUR INDEX	CODE	WEIGHT grams	MIN. PACK QUANTITY	SIZES
	MUSHROOM OPERATOR Ø40 TWIST TO RELEASE	■	PPFN1R4N4X	44	10	
	MUSHROOM OPERATOR WITH VISION Ø40 TWIST TO RELEASE	■	PPFN1R4S4X	46	10	
	MUSHROOM OPERATOR Ø40 WITH KEY RELEASE	■	PPFN1C4NX4X (not EN ISO 13850)	76	10	
	MUSHROOM OPERATOR Ø40 PUSH-PULL	■	PPFN1P4N4X	44	10	
	MUSHROOM OPERATOR Ø40 PUSH-PULL WITH VISION	■	PPFN1P4S4X	46	10	

**TECHNICAL NOTES**

- All operators comply with the relevant European and American standard.
- EN ISO 13850: Machine safety - Emergency stop operators, functional characteristics - Design guidelines.
- IEC/EN6097-5-1.
- Comply with the standard IEC/EN60204-1: Machine safety - Machine electrical circuits - General guidelines.
- The push buttons are designed with a load charge mechanism to ensure a reliable operation and stoppage, or blockage, in the activate position. The combination with positive switching NC contacts and the presence of the "status" indicator on some models, guarantee a high degree of reliability and effectiveness.

**ROTARY SWITCHES Ø22 | NEMA 4-4X**

**WITH OPERATOR**

**WITH LIGHT OPERATOR**

**WITH KEY**

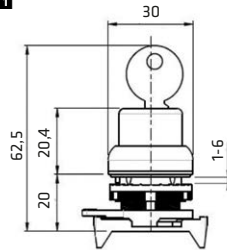
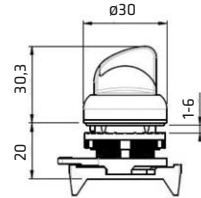

POSITION	COLOUR INDEX	CODE	COLOUR INDEX	CODE	KEY REMOVAL			CODE
					L	O	R	
 90°	■	PSMB1D0GL4X	■	PSML1D0GL4X		*		PSCR8D0CGL4X
	■	PSMB2D0GL4X	■	PSML2D0GL4X			*	PSCR8D0EGL4X
	■	PSMB3D0GL4X	■	PSML3D0GL4X			*	PSCR8D0NGL4X
	■	PSMB4D0GL4X	■	PSML4D0GL4X			*	
	■	PSMB5D0GL4X	■	PSML5D0GL4X			*	
 45°	■	PSMB1D1GL4X	■	PSML1D1GL4X		*		PSCR8D1CGL4X
	■	PSMB2D1GL4X	■	PSML2D1GL4X			*	PSCR8D1EGL4X
	■	PSMB3D1GL4X	■	PSML3D1GL4X			*	PSCR8D1NGL4X
	■	PSMB4D1GL4X	■	PSML4D1GL4X			*	
	■	PSMB5D1GL4X	■	PSML5D1GL4X			*	
 45°	■	PSMB1D2GL4X	■	PSML1D2GL4X			*	PSCR8D2CGL4X
	■	PSMB2D2GL4X	■	PSML2D2GL4X			*	
	■	PSMB3D2GL4X	■	PSML3D2GL4X			*	
	■	PSMB4D2GL4X	■	PSML4D2GL4X			*	
	■	PSMB5D2GL4X	■	PSML5D2GL4X			*	
 45°	■	PSMB1T0GL4X	■	PSML1T0GL4X	*	*	*	PSR8T0CGL4X
	■	PSMB2T0GL4X	■	PSML2T0GL4X	*	*	*	PSR8T0AGL4X
	■	PSMB3T0GL4X	■	PSML3T0GL4X	*	*	*	PSR8T0EGL4X
	■	PSMB4T0GL4X	■	PSML4T0GL4X	*	*	*	PSR8T0GGL4X
	■	PSMB5T0GL4X	■	PSML5T0GL4X	*	*	*	PSR8T0HGL4X
 45°	■	PSMB1T3GL4X	■	PSML1T3GL4X			*	PSCR8T3CGL4XL
	■	PSMB2T3GL4X	■	PSML2T3GL4X			*	
	■	PSMB3T3GL4X	■	PSML3T3GL4X			*	
	■	PSMB4T3GL4X	■	PSML4T3GL4X			*	
	■	PSMB5T3GL4X	■	PSML5T3GL4X			*	
 45°	■	PSMB1T2GL4X	■	PSML1T2GL4X		*		PSCR8T2CGL4X
	■	PSMB2T2GL4X	■	PSML2T2GL4X			*	PSCR8T2AGL4X
	■	PSMB3T2GL4X	■	PSML3T2GL4X			*	PSCR8T2HGL4X
	■	PSMB4T2GL4X	■	PSML4T2GL4X			*	
	■	PSMB5T2GL4X	■	PSML5T2GL4X			*	
 45°	■	PSMB1T1GL4X	■	PSML1T1GL4X		*		PSCR8T1CGL4X
	■	PSMB2T1GL4X	■	PSML2T1GL4X			*	PSCR8T1EGL4X
	■	PSMB3T1GL4X	■	PSML3T1GL4X			*	PSCR8T1NGL4X
	■	PSMB4T1GL4X	■	PSML4T1GL4X			*	
	■	PSMB5T1GL4X	■	PSML5T1GL4X			*	

1 For standard rotary switches suitable to operate a central contact, replace the letter "B" with the letter "C": PSMB1C0GL4X  
2 For rotary switches with Left - Right operating angles replace the letters "DO" with "SD": PSMB1SD0GL4X or PSCR8SD0GL4X

\* Key removable position

**OPERATOR CAPS Ø22 | NEMA 4-4X**

**MOMENTARY FLUSH PUSH BUTTONS**



SYMBOL	COLOUR	CODE	SYMBOL	COLOUR	CODE
	■	PPRN2GL4X/I		■	PPRN2GL4X/ON
	■	PPRN1GL4X/O		■	PPRN1GL4X/OFF
	■	PPRN2GL4X/II		■	PPRN5GL4X/F
	■	PPRN2GL4X/START		■	PPRN8GL4X/F
	■	PPRN1GL4X/STOP			

Available others symbols on request, also in different languages and colours.

**ACCESSORIES | NEMA 4-4X**

**CENTRAL CONTACT OPERATION**



DESCRIPTION	CODE
NEMA 4X SERIES	11708555

**KEY FIXING BULB EXTRACTOR**



CODE
PCF

**CONTACTS SUPPORT**



DESCRIPTION	CODE	DESCRIPTION	CODE
TO CONTACT ELEMENTS PL, PCW, PSC	PPELN8	TO FIVE CONTACT ELEMENTS PL, PCW, PSC	PPELN8-5

**FASTON CONNECTORS AND FOR PCB**



DESCRIPTION	CODE	DESCRIPTION	CODE
FASTON 6,3x0,8	11708341	PCB	11708235

TO SCREW CONTACTS PL

**SPECIAL FRAMES ON REQUEST**

• **SPECIAL FRAMES: SHROUDED NEMA**

The auxiliary controls of NEMA Series are available also with shrouded seal.

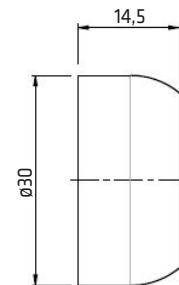

NEMA Series

**TECHNICAL DATA | ELECTRICAL CHARACTERISTICS**

**CONTACT BLOCKS**

EC/EN 60947-5-1 CHARACTERISTICS		PL004001-PL004002	PCW01-PCW10 / PSC01-PSC10
Rated insulation voltage Ui	V	690*	690*
Rated impulse withstand voltage Uimp	kV	4*	4*
Operating frequency	Hz	50/60*	50/60*
Rated thermal current Ith	A	16*	16*
Rated thermal current in enclosed Ithe	A	10*	10*
<b>RATED OPERATING CURRENT Ie:</b>			
AC15: Alternate current	V	24 60 110 230 400 440 500 690	24 60 110 240 400 440 500 690
	A	16* 12 8 6 4,5 3,5 1* 1	16* 12 5 5* 4 4 4* 2*
DC13: Direct current	V	24 48 60 110 220	24 48 60 110 250
	A	2* 1,2 0,85 0,4 0,25*	2 2* 1* 0,4 0,4*
Conditional short circuit withstand current	A	1000*	1000*
Fuse rating gG	500V	10A*	10A*
Contact insulation resistance	mΩ	<25	<25
Switching mechanism		Slow break double gap contacts	Slow break double gap contacts
Contact duty		⊕ NC contact with positive opening	⊕ NC contact with positive opening
Minimum tripping force		4N	4N
Electrical life AC15	mil. cycles	1A/1,5 - 2A/0,5 - 3A/0,25	1A/1,5 - 2A/0,5 - 3A/0,25
<b>UL 508 CHARACTERISTICS</b>			
General Use		10A-600V ac - 2,5A-125V dc	10A-600V ac - 2,5A-125V dc
Heavy Duty (HD) category		A600-Q600	A600-Q600

**LAMP HOLDER**

EC/EN 60947-5-1 CHARACTERISTICS		BUILT-IN LED
Rated insulation voltage Ui	V	400
Rated operating voltage Ue	V	AC/DC 12-24
	V	AC/DC 48
	V	AC/DC 110
	V	AC 220
Max rated power	W	-
Power supply		-
Lamp fixing system		-

**TECHNICAL DATA | ELECTRICAL CHARACTERISTICS**

STANDARD CONFORMITY	UL
Approvals	UL508, CSA 22.2
Protection class	Buttons and switches, Multifunction push button
	Emergency push buttons EN ISO 13850
	Type 1-4-4X
Material Group	II
Pollution Grade	3
Ambient Temperature	Operating: -25 +70
	Storage: -30 +70
Climate Protection	Hot damp
	Unsettled Hot damp
<b>Mechanical life:</b>	
Push buttons with colour cap	3
Standard push buttons with lens cap	1
Standard rotary switches	1
Rotary switches with lens	0,5
Emergency stop push buttons with release	0,3

