

PANEL SEALED METAL CAPACITIVE TOUCH SWITCHES

These rugged electro tuoch switches are available in stainless steel or aluminum alloy housings and come in momentary or maintained action. The variety of switches diameter and customized symbol make the series EC ideal for many applications in the transportation, security, shopping mall, food processing and medical markets.

APPLICATIONS

- Outdoor Controls
- Security Equipment
- Medical Equipment
- Food Processing
- Military Equipment
- Industrial Machinery
- Transportation: Mass-transit, Lift Truck

Series EC



KEY FEATURES:

- Momentary or Maintained Action
- Stainless Steel/ Aluminum Housing
- Ring Illumination
- Variety of LED Colors
- Customized Symbol
- Panel Sealed to IP67
- Series EC:19,22,25,30mm Panel Sealed Metal

ORDERING INFORMATION:

Series:	Switch Function:	Housing Material:	*Illumination:	LED Color 1:	LED Color 2:
19 Switches Diameter 19mm	1 Normally Open, Momentary	1 Stainless	02 Ring Illumination	N None	N None
22 Switches Diameter 22mm	2 Normally Open, Maintained	2 Aluminum	03 Power/ Standby Symbol	R Red	R Red
25 Switches Diameter 25mm	3 Normally Closed, Momentary	R Aluminum, Red Anodized	Laser Carving	G Green	G Green
30 Switches Diameter 30mm	4 Normally Closed, Maintained	G Aluminum, Green Anodized		B Blue	B Blue
		K Aluminum, Black Anodized		W White	W White
				C Cyan	C Cyan
				V Violet	V Violet
<div> <div>EC</div> <div>M-</div> <div></div> <div></div> <div></div> <div></div> <div></div> </div>					

*Can be Added by The Customized Symbol.

SERIES EC: PANEL SEALED METAL TOUCH SWITCHES

PRODUCT DRAWINGS

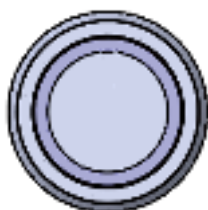

Ring Illumination
Non-Symbol



Ring Illumination
Standby Symbol



Ring Illumination
Customized Symbol

EC22M SERIES

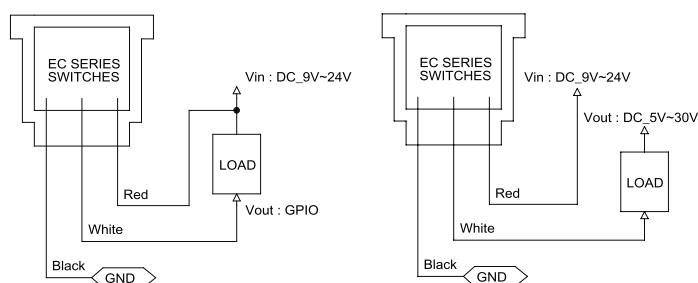
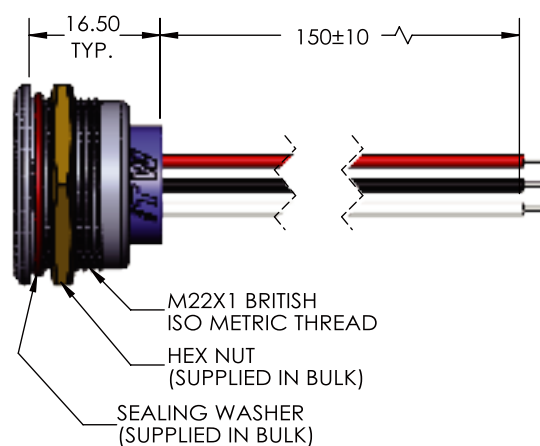
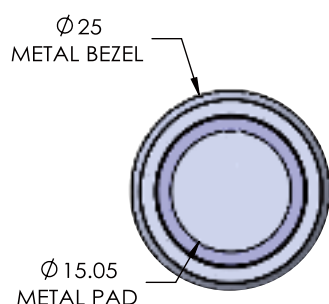

SUGGESTED CIRCUITRY

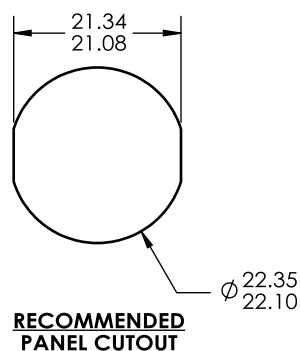

MECHANICAL CHARACTERISTICS:

PANEL THICKNESS:

0.5 - 4.5 mm

NUT TORQUE FORCE:

MAX 10 LB/in [11.5 kgf/cm]

ENVIRONMENTAL SPECIFICATIONS:

ACTUATOR INGRESS PROTECTION:

IP67 (Front Panel)

OPERATING TEMPERATURE:

-40° to +185°F [-40° to +85°C]

IMPACT RESISTANCE:

IK10

ELECTRICAL SPECIFICATIONS:

CURRENT RATINGS:

1.5A@9~24VDC

POWER CONSUMPTION:

ACTIVE : 1.5mA / SLEEP : 2.8uA

LED POWER CONSUMPTION:

MAX 20mA

ELECTRICAL LIFE:

10kk CYCLES NOMINAL

ESD RESISTANCE:

2kV (HUMAN BODY MODEL ESD)

CONTACT RESISTANCE:

MAX 65 mOHMS