

SENSITIVE PUSHBUTTON SWITCHES • CAPACITIVE TECHNOLOGY



## DISTINCTIVE FEATURES

capacitive technology

IP68/IP69K and IK10

illuminated versions

auto-calibration function

NO or NC contact, momentary or latched

**DRAGON** capacitive pushbuttons activate with the touch of a finger. An automatic calibration function ensures that the button constantly adapts to changes in its environment. As sensitive as a touchscreen, those capacitive buttons are perfect for industrial applications where repetitive activation can cause operator fatigue.

## ELECTRICAL SPECIFICATIONS

Max current : 200 mA, 24 VDC

Power supply : 5VDC, 12VDC or 24VDC

Contact type : OFF-(ON) or OFF-ON

Consumption (no LED) : 7mA

Consumption (with LED) : 25mA

Electrical life : 50 million cycles

Output : NPN or PNP

LED circuit can be independent or linked to contact

## ENVIRONMENTAL SPECIFICATIONS

Operating temperature : from -20°C to +65°C

Impact resistance : IK10

Ingress protection : IP68 and IP69K following IEC60529

EMC : compliant with EN61000-4-2 standards

## MECHANICAL SPECIFICATIONS

Actuation force : 0 N

Materials :

Body : Stainless steel 316L or Anodized aluminum

Key : Stainless steel 316L or Anodized aluminum

Wires (F) : stranded 0,22mm<sup>2</sup>, L=300mm

Connector ( C ) : HE14 6V, compatible with AMP/TYCO281839-3

## GENERAL SPECIFICATIONS

Mounting hole : from 16,2 to 25,2 mm

Panel thickness : from 0,75 to 4mm

## BUILD YOUR PART NUMBER

| Family | Diameter | Material | Key | Connection | Illumination | Output | Contact | Function | LED colour | LED circuit |
|--------|----------|----------|-----|------------|--------------|--------|---------|----------|------------|-------------|
| DR     | 22       | S        | R1  | F          | A            | Z      | NO      | M        | G          | S           |

**MOUNTING HOLE**

16 dia. 16mm

19 dia. 19mm

22 dia. 22mm

25 dia. 25mm

**MATERIAL**

S Stainless 316L

A Anodized Aluminum<sup>1</sup>

**KEY TYPE**

R1 **Dia 16 only**  
Flat, height 4,5mm  
Available with illuminated ring

R2 **Dia 19 only**  
Flat, height 3mm  
Available with illuminated ring

RA **Dia 19 only**  
Flat with chamfer, height 2mm  
Available with illuminated ring

RZ **Dia 22 et 25 only**  
Flat, height 4,5mm  
Available with illuminated ring L or F

RY **Dia 22 et 25 only**  
Flat with chamfer, height 4,5mm  
Available with illuminated ring L or F

**CONNECTION TYPE**

F Wires

C Connector

**ILLUMINATION TYPE**

- Without illumination

A Standard ring, 5Vdc

N Standard ring, 12Vdc

K Standard ring, 24Vdc

P Large ring, 5Vdc

J Large ring, 12Vdc

Y Large ring, 24Vdc

**Options P, J, Y dia. 22 & 25 only**

**OUTPUT**

- NPN

Z PNP

**CONTACT TYPE**

NO Normally Open

NC Normally Closed

**ACTUATION TYPE**

M Momentary OFF-(ON)

L Latched OFF-ON

**CIRCUIT LED**

S Independent

C Linked to contact

**LED COLOUR**

- No illumination

R Red

G Green

Y Yellow

B Blue

W White

RW Red / White

RB Red / Blue

RG Red / Green

RY Red / Yellow

GB Green / Blue

GY Green / Yellow

GW Green / White

BY Blue / Yellow

BW Blue / White

YW Yellow / White

## WIRING DIAGRAMS

| Output | Non-illuminated | 1LED             |             | 2 LEDs           |             | Legend  |
|--------|-----------------|------------------|-------------|------------------|-------------|---|
|        |                 | Output indicator | Independent | Output indicator | Independent |   |
| NPN    |                 |                  |             |                  |             | R red +V<br>Black black GND<br>W white output<br>A = samecolor as LED |
|        |                 |                  |             |                  |             |   |
| PNP    |                 |                  |             |                  |             |   |
|        |                 |                  |             |                  |             |   |

## ABOUT THIS RANGE

<sup>1</sup> Anodizing colour to be selected on order. Might be subject to MOQ.  
Our pushbuttons are always supplied with hex or knurled nut and washer.

**⚠ SOME CONFIGURATIONS MIGHT NOT BE AVAILABLE OR SUBMITTED TO M.O.Q.**

**FOR ALL YOUR CUSTOM REQUESTS, CONTACT US !**  
sales@kynoppe.com

## CONFIGURATION EXAMPLES

### DIA.16 MM □



DR16SR1FNN0MBS

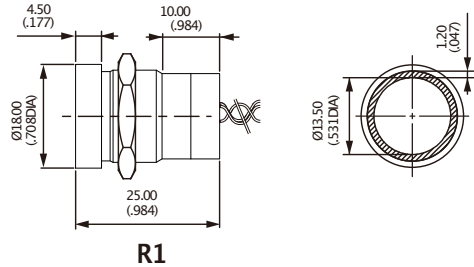

### DIA.19 MM □



DR19SR2FNN0MBS

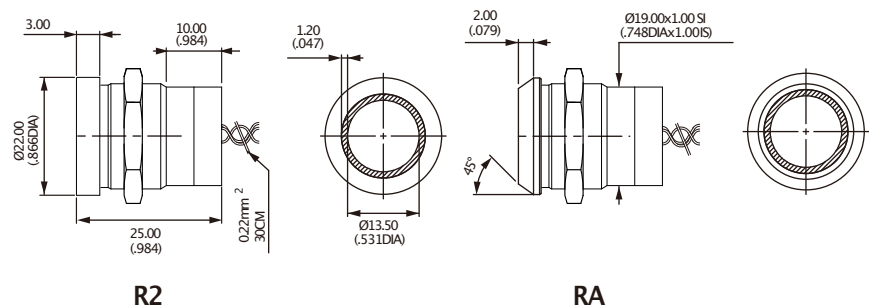

### DIA.22 MM □



DR22SRYFPN0MRS

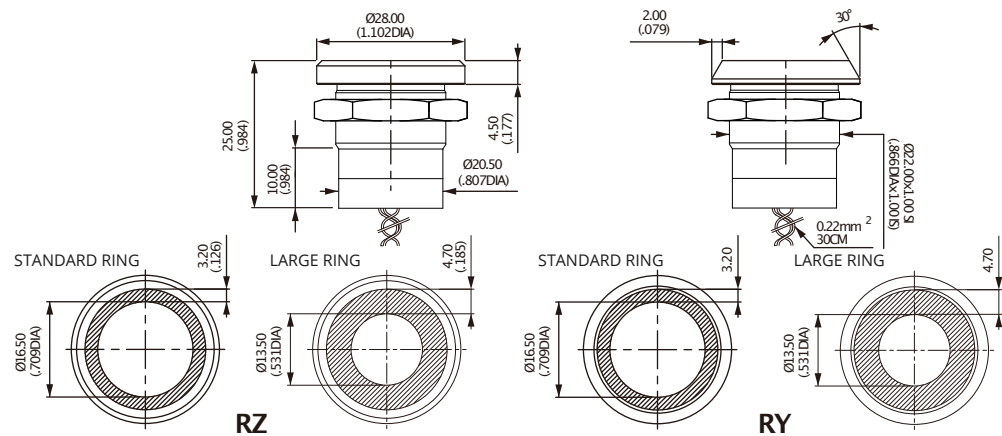

### DIA.25 MM □



DR25SRZFNN0MBS

